

KPR-46EX30 / 46EX32

RM-Y109

SERVICE MANUAL

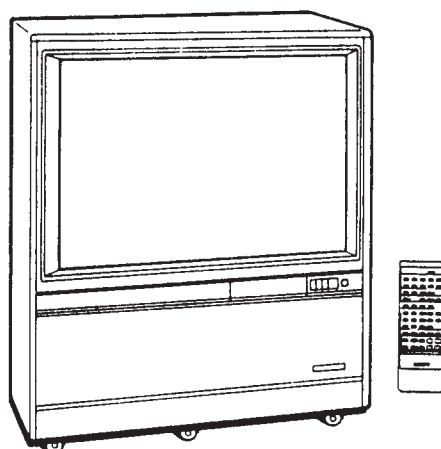

US Model

KPR-46EX30

Chassis No. SCC-D65G-A

KPR-46EX32

Chassis No. SCC-D65E-A

MODELS OF THE SAME SERIES	
KPR-46EX20	

CX7948A
CX20125
M5220L

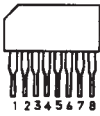

CXA1012AS

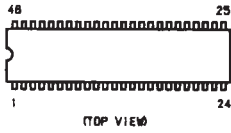

CXA1268P

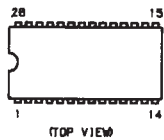

CXA1411Q
CXA1412Q

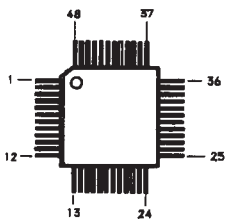

LA7953
M50461-064SP

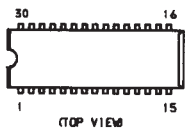

ML393P
RC4558C
TL082CP
μPC393C
μPC4558P

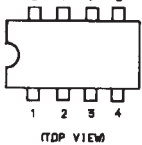

MB88E734-132

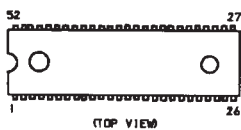

MC14052BF

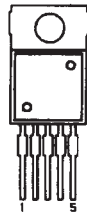

MC14066BF

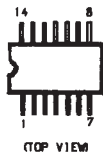

MC33174M
MC4741CM

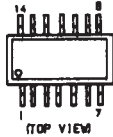

RC78L 05A
RC78L 12A
RC79L 12A



RC78M05FA
RC8712FA



RC78M93F0



RC79L 05A

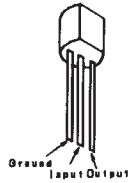

STK4412

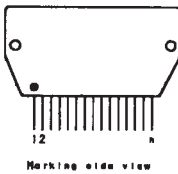

MC14052BCP
μP06326C

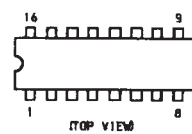

LM324N
MC14066BCP
μPC1349C

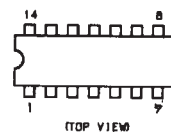

0TC124ES
0TC144ES



2SA1013-0
2SC2383-0
2SC2551-R0
2SC3468-E
2SD788-5



2SA1091-0
2SC1815-Y
2SC2551-0



2SA1175-HFE
2SC2785-HFE



2SA1220A-P
2SB649-C
2SC2688-LK
2SC2690A-Q
2SC2690A-P

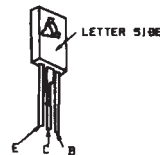

2SA1237-F
2SC3064-E
2SC2064-F



2SA1428-Y
2SC3668-0
2SC3668-Y



2SB861-C
2SB1094-L
2SC3675
2SD1399-CA
2SD1406-YGR



2SC1623-L6

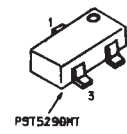

2SC2555-2



2SD1887-CA

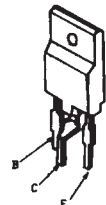

10E-2
ER028-08S
R024FB2

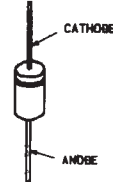

1SS119
ERC38-06
R010ESB2
R012ESB1
R013ESB1
R013ESB2
R015ESB1
R03.3ESB2
R033ESB1
R033ESB2
R03.6ESB1
R039ESB2
R05.1ESB2
R05.6ESB1

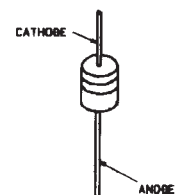

ERC06-15S
RU-1C

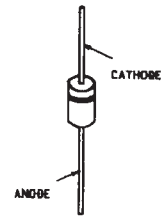

1SVB40

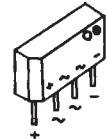

S3WB60Z



SL162B

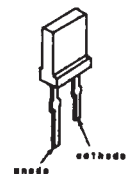

U05G

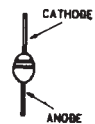

SECTION 7 EXPLODED VIEWS

NOTE:

- The mechanical parts with no reference number in the exploded views are not supplied.
- The construction parts of an assembled part are indicated with a collation number in the remark column.
- Items marked "★" are not stocked since they are seldom required for routine service. Some delay should be anticipated when ordering these items.

The components identified by shading and mark **A** are critical for safety.
Replace only with part number specified.

7-1. CONTROL PANEL

●: BVTP3 × 12 7-685-648-79

□: SCREW, TAPPING, HEXAGON HEAD 4-378-522-01

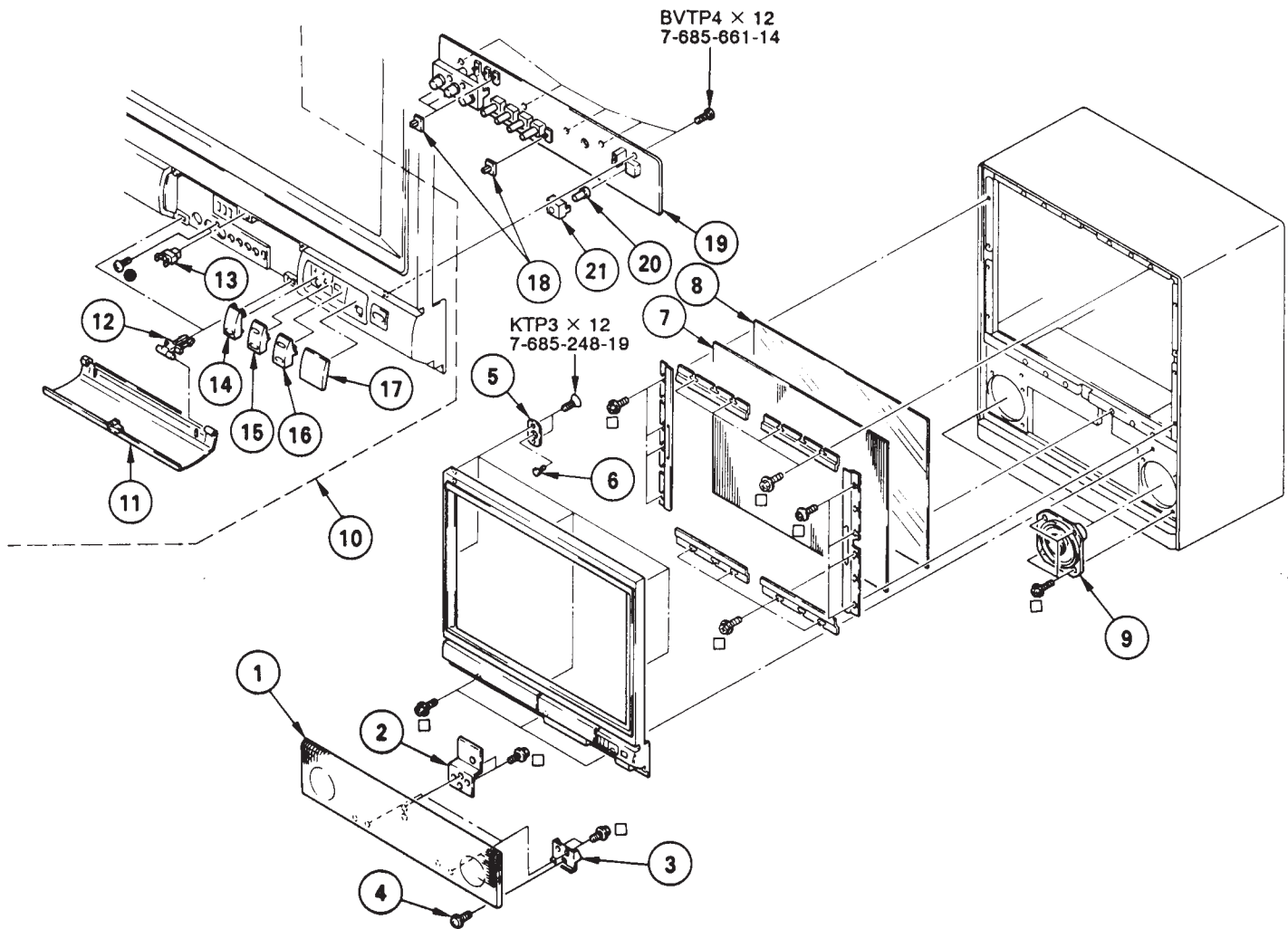

REF.NO.	PART NO.	DESCRIPTION	REMARK	REF.NO.	PART NO.	DESCRIPTION	REMARK
1	X-4389-580-1	GRILLE ASSY, SPEAKER (KPR-46EX30 ONLY)		12	3-703-035-11	SHAFT, LID	
	X-4029-413-1	GRILLE ASSY, SPEAKER (KPR-46EX32 ONLY)		13	4-392-036-01	CATCHER, PUSH	
2	*4-389-532-01	HOLDER (U), SPEAKER GRILLE		14	4-389-522-01	BUTTON (VIDEO)	
3	*4-390-648-01	HOLDER (L), SPEAKER GRILLE		15	4-389-521-01	BUTTON (VOLUME CHANNEL)	
4	3-701-810-91	SCREW, TERMINAL		16	4-389-521-11	BUTTON (VOLUME CHANNEL)	
5	4-838-453-00	SUPPORT		17	4-397-029-01	COVER, INDICATOR	
6	4-838-452-00	STRIKE		18	4-381-073-11	KEY TOP, SLIDE	
7	4-389-502-01	PLATE (L), DIFFUSION		19	*1-625-921-11	H BOARD	
8	4-397-030-11	PLATE (TFF), DIFFUSION		20	*4-389-517-01	GUIDE (R), LIGHT	
9	1-544-014-11	SPEAKER		21	*4-381-686-01	BRACKET (B), LIGHT GUIDE	
10	X-4389-581-1	FRAME ASSY, SCREEN	11-17				
11	X-4389-577-1	DOOR ASSY, CONTROL PANEL					

7-2. MIRROR BLOCK

●: BVTP3 × 12 7-685-648-79

△: BVTP4 × 12 7-685-661-79

□: SCREW, TAPPING, HEXAGON HEAD 4-378-522-01

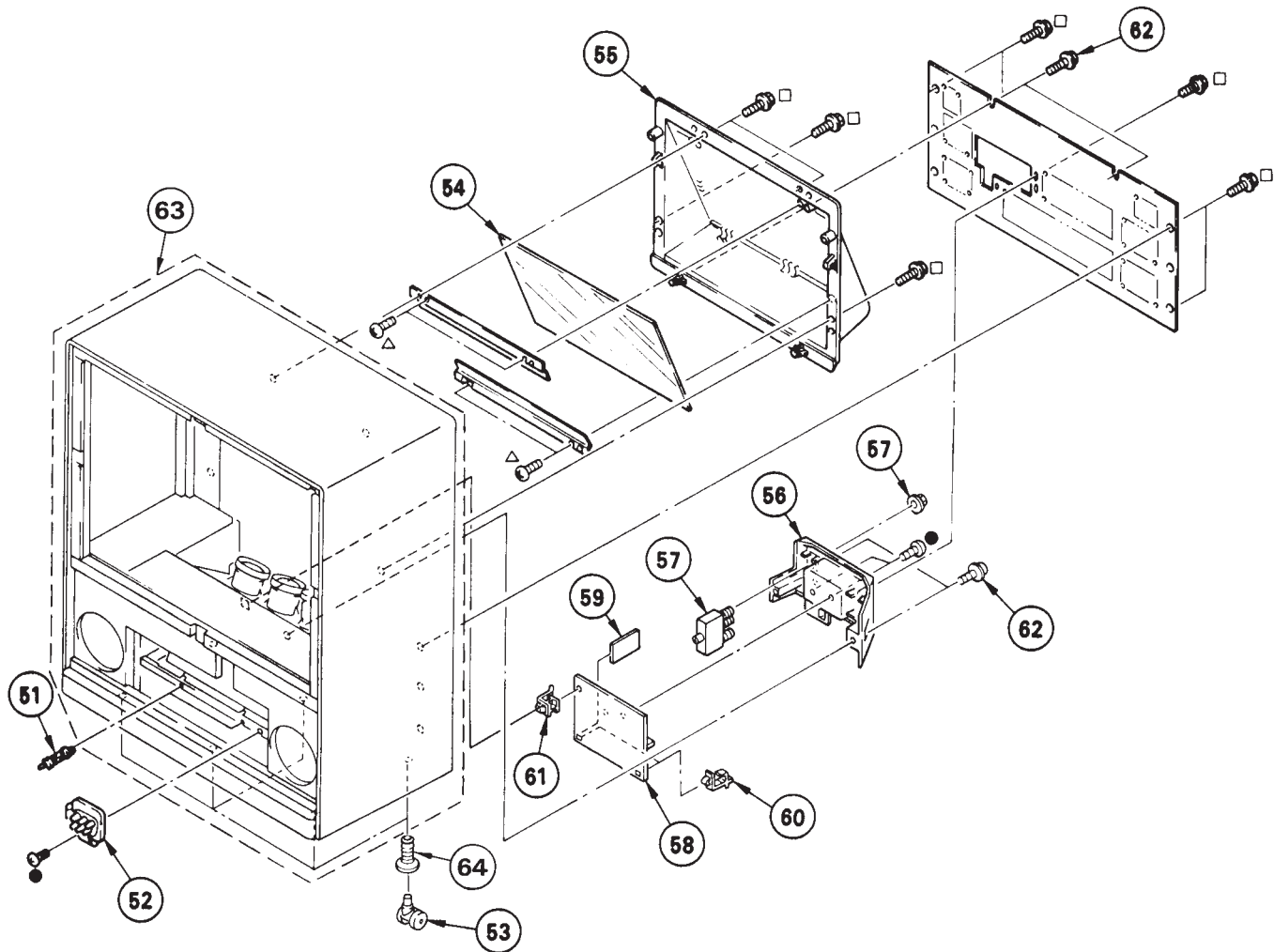

REF.NO.	PART NO.	DESCRIPTION
51	*4-914-008-01	HOLDER, PCB
52	△.1-237-582-21	RESISTOR ASSY, HIGH-VOLTAGE
53	2-133-901-11	CASTER
54	4-389-538-01	MIRROR, REFLECTION
55	4-389-504-01	COVER, MIRROR
56	X-4389-578-1	PANEL ASSY, CONNECTOR
57	△.1-417-177-11	SELECTOR, ANTENNA (AS-1)
58	*A-1373-238-A	U BOARD, COMPLETE

REF.NO.	PART NO.	DESCRIPTION	REMARK
59	*A-1394-227-A	SX BOARD, COMPLETE	
60	*3-682-612-00	CLIP (B), ANCHOR	
61	*4-321-929-00	HOLDER, PC BOARD	
62	3-701-810-91	SCREW, TERMINAL	
63	*X-4029-419-1	CABINET ASSY (KPR-46EX32 ONLY)	64
	*X-4389-579-1	CABINET ASSY (KPR-46EX30 ONLY)	64
64	2-133-902-01	SOCKET, CASTER	

The components identified by shading and mark △ are critical for safety.
Replace only with part number specified.

7-3. PICTURE TUBE

■ : BVTP4 × 16 7-685-663-79

□ : SCREW, TAPPING, HEXAGON HEAD 4-378-522-01

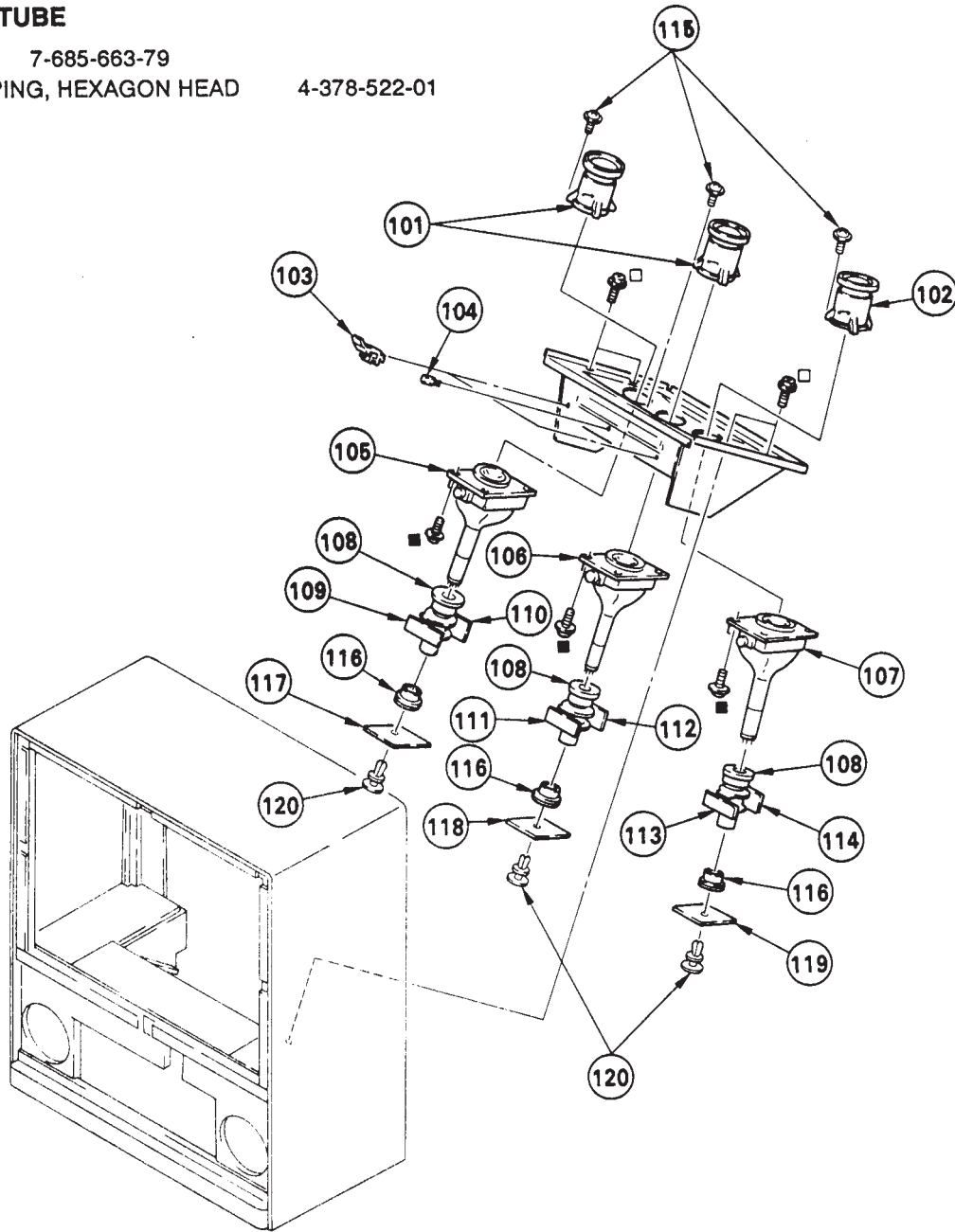

REF.NO.	PART NO.	DESCRIPTION	REMARK	REF.NO.	PART NO.	DESCRIPTION	REMARK
101	4-389-503-02	LENS		111	*1-625-930-11	XG BOARD	
102	4-389-503-12	LENS		112	*1-625-933-11	YG BOARD	
103	*3-703-141-00	HOLDER, PCB		113	*1-625-931-11	XB BOARD	
104	*4-861-614-00	HOLDER, PC BOARD		114	*1-625-934-11	YB BOARD	
105	▲.8-734-023-05	PICTURE TUBE (SD-208 (R))		115	3-701-810-91	SCREW, TERMINAL	
106	▲.8-734-021-05	PICTURE TUBE (SD-208 (G))		116	▲.1-452-443-13	NECK ASSY, PICTURE TUBE (NA367)	
107	▲.8-734-022-05	PICTURE TUBE (SD-208 (B))		117	*A-1331-069-A	CR BOARD, COMPLETE	
108	▲.1-451-322-11	DEFLECTION YOKE (Y636PA4)		118	*A-1331-070-A	CG BOARD, COMPLETE	
109	*1-625-929-11	XR BOARD		119	*A-1331-071-A	CB BOARD, COMPLETE	
110	*1-625-932-11	YR BOARD		120	3-531-576-31	RIVET (DIA,3), NYLON	

The components identified by shading and mark ▲ are critical for safety.
Replace only with part number specified.

7-4. CHASSIS

●: BVTP3 × 12 7-685-648-79

△: BVTP4 × 12 7-685-661-79

□: SCREW, TAPPING, HEXAGON HEAD 4-378-522-01

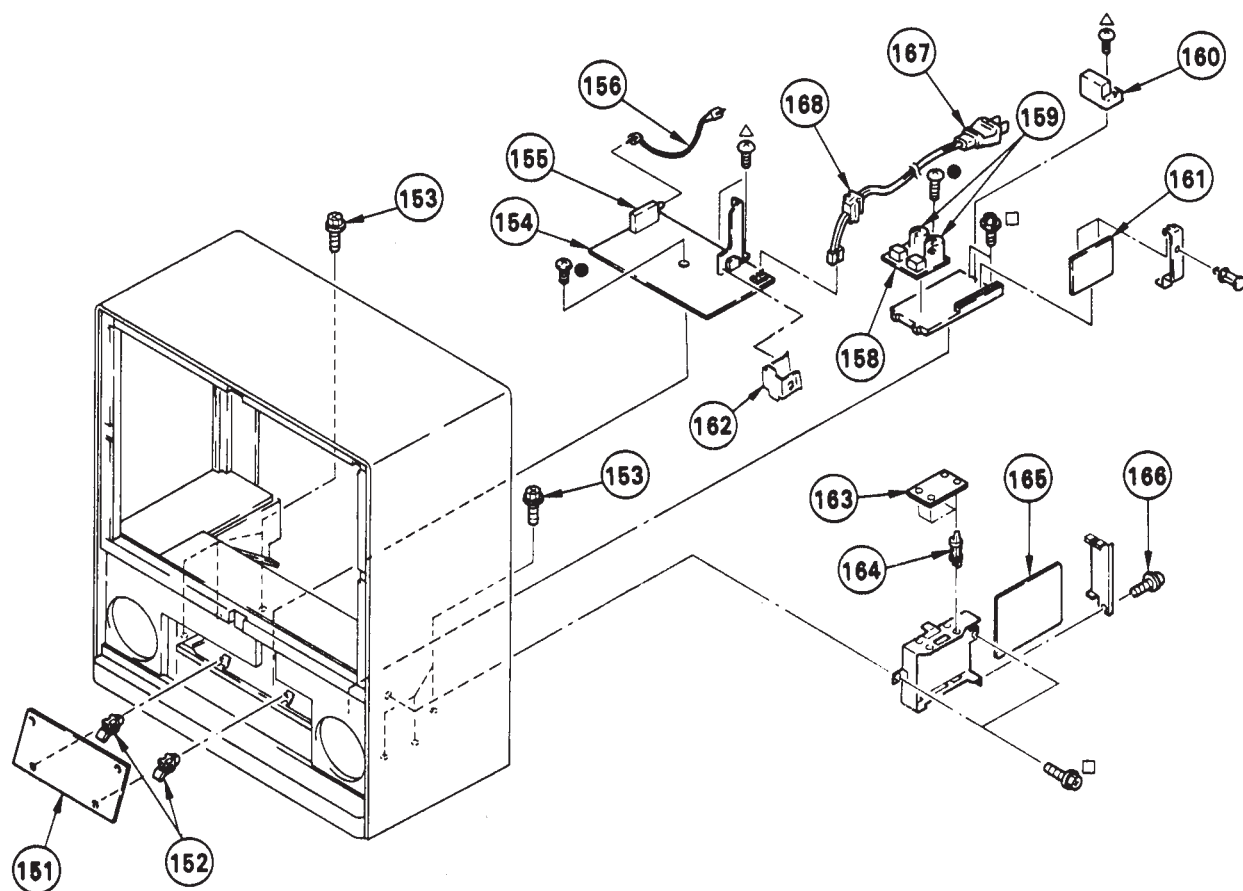

REF.NO.	PART NO.	DESCRIPTION	REMARK	REF.NO.	PART NO.	DESCRIPTION	REMARK
151	*A-1341-370-A	D BOARD, COMPLETE		160	△ 1-453-108-11	DC BLOCK, HIGH-VOLTAGE	
152	*3-703-141-00	HOLDER, PCB		161	*A-1195-039-A	P BOARD, COMPLETE	158
153	4-378-522-21	SCREW, TAPPING, HEXAGON HEAD		162	*4-399-421-01	SPRING, TR RETAINER	
154	*A-1296-731-A	A BOARD, COMPLETE		163	*1-627-633-11	F BOARD	
156	*1-555-400-00	CABLE, PIN		164	*3-703-353-12	SUPPORTER, PC BOARD	
158	*1-625-924-11	PC BOARD		165	△ 1-453-108-11	DC BLOCK, HIGH-VOLTAGE	
				166	3-701-810-91	SCREW, TERMINAL	

The components identified by shading and mark △ are critical for safety.
Replace only with part number specified.

NOTE:

The components identified by shading and mark Δ are critical for safety.
Replace only with part number specified.

• Items marked " * " are not stocked since they are seldom required for routine service. Some delay should be anticipated when ordering these items.

• All variable and adjustable resistors have characteristic curve B, unless otherwise noted.

RESISTORS

• All resistors are in ohms
• F : nonflammable

When indicating parts by reference number, please include the board name.

CAPACITORS

• MF : μ F, PF : μ F

COILS

• MMH : mH, UH : μ H

• The components identified by Δ in this manual have been carefully factory-selected for each set in order to satisfy regulations regarding X-ray radiation. Should replacement be required, replace only with the value originally used.

REF.NO.	PART NO.	DESCRIPTION	REMARK	REF.NO.	PART NO.	DESCRIPTION	REMARK
	*A-1195-039-A	P BOARD, COMPLETE *****		C833	1-124-925-11	ELECT 2.2MF 20% 50V	
A-1-459-108-11	DC BLOCK, HIGH-VOLTAGE			C834	1-102-973-00	CERAMIC 100PF 5% 50V	
*1-508-765-00	PIN, CONNECTOR (5MM PITCH) 3P			C835	1-124-927-11	ELECT 4.7MF 20% 50V	
*1-508-766-00	PIN, CONNECTOR (5MM PITCH) 4P			C836	1-130-475-00	MYLAR 0.0022MF 5% 50V	
*1-508-784-00	PIN, CONNECTOR (5MM PITCH) 1P			C837	1-136-169-00	FILM 0.22MF 5% 50V	
*1-508-786-00	PIN, CONNECTOR (5MM PITCH) 2P			C838	1-130-475-00	MYLAR 0.0022MF 5% 50V	
*1-564-506-11	PLUG, CONNECTOR 3P			C839	1-102-106-00	CERAMIC 100PF 10% 50V	
*1-564-507-11	PLUG, CONNECTOR 4P					<DIODE>	
*1-564-508-11	PLUG, CONNECTOR 5P			D506	8-719-911-19	DIODE 1SS119	
*4-341-751-01	EYELET			D801	8-719-928-08	DIODE ERD28-08S	
*4-341-752-01	EYELET			D802	8-719-300-80	DIODE RU-1C	
*4-363-146-00	HEAT SINK, V.OUT			D803	8-719-109-85	DIODE RD5.1ES-B2	
4-383-023-01	SPACER, MICA			D804	8-719-911-19	DIODE 1SS119	
	<CAPACITOR>			D805	8-719-911-19	DIODE 1SS119	
C516	1-106-381-12	MYLAR 0.039MF 10% 100V		D806	8-719-109-85	DIODE RD5.1ES-B2	
C517	1-106-391-12	MYLAR 0.1MF 10% 200V		D807	8-719-109-85	DIODE RD5.1ES-B2	
C521	1-106-351-00	MYLAR 0.0022MF 10% 100V		D808	8-719-911-19	DIODE 1SS119	
C802	1-123-024-21	ELECT 33MF 160V		D809	8-719-911-19	DIODE 1SS119	
C803	1-136-729-11	FILM 1.5MF 5% 400V		D810	8-719-911-19	DIODE 1SS119	
C804	1-108-700-11	MYLAR 0.047MF 10% 200V		D811	8-719-109-85	DIODE RD5.1ES-B2	
C805	1-102-030-00	CERAMIC 330PF 10% 500V		D812	8-719-911-19	DIODE 1SS119	
C806	1-136-165-00	FILM 0.1MF 5% 50V		D813	8-719-911-19	DIODE 1SS119	
C807	1-123-875-11	ELECT 10MF 20% 50V		D815	8-719-110-36	DIODE RD13ES-B2	
C808	1-124-360-00	ELECT 1000MF 20% 16V		D874	8-719-110-78	DIODE RD33ES-B2	
C809	1-124-791-11	ELECT 1MF 20% 50V				<IC>	
C810	1-124-791-11	ELECT 1MF 20% 50V		IC801	8-759-982-26	IC RC78L12A	
C811	1-124-902-00	ELECT 0.47MF 20% 50V		IC802	8-759-987-16	IC LM393P	
C812	1-102-973-00	CERAMIC 100PF 5% 50V		IC803	8-759-990-82	IC TL082CP	
C813	1-102-244-00	CERAMIC 220PF 10% 500V		IC804	8-759-987-16	IC LM393P	
C814	1-108-704-11	MYLAR 0.1MF 10% 200V		IC805	8-759-100-75	IC UPC1394C	
C815	1-108-692-11	MYLAR 0.01MF 10% 200V				<COIL>	
C816	1-123-875-11	ELECT 10MF 20% 50V		L502	1-459-060-00	COIL,DYNAMIC CONVERSION CHOKE	
C817	1-124-119-00	ELECT 330MF 20% 16V		L803	1-459-155-00	COIL (WITH CORE) 45UH	
C818	1-102-824-00	CERAMIC 470PF 5% 50V		L804	A-1-419-132-11	COIL, DYNAMIC CONVERSION CHOKE	
C819	1-136-169-00	FILM 0.22MF 5% 50V				<NEON LAMP>	
C820	1-123-875-11	ELECT 10MF 20% 50V		NL1	1-519-108-99	LAMP,NEON ASSY	
C821	1-123-875-11	ELECT 10MF 20% 50V				<TRANSISTOR>	
C822	1-124-034-51	ELECT 33MF 20% 16V		Q507	8-729-804-48	TRANSISTOR 2SC3675	
C823	1-123-875-11	ELECT 10MF 20% 50V		Q801	A-8-729-201-61	TRANSISTOR 2SC2555-1	
C824	1-124-034-51	ELECT 33MF 20% 16V		Q802	8-729-119-80	TRANSISTOR 2SC2688-LK	
C825	1-124-034-51	ELECT 33MF 20% 16V		Q803	8-729-119-76	TRANSISTOR 2SA1175-HFE	
C826	1-123-875-11	ELECT 10MF 20% 50V					
C827	1-123-875-11	ELECT 10MF 20% 50V					
C828	1-123-875-11	ELECT 10MF 20% 50V					
C829	1-124-034-51	ELECT 33MF 20% 16V					
C830	1-123-875-11	ELECT 10MF 20% 50V					
C831	1-108-638-11	MYLAR 0.1MF 10% 100V					
C832	1-123-875-11	ELECT 10MF 20% 50V					

REF.NO.	PART NO.	DESCRIPTION	REMARK	REF.NO.	PART NO.	DESCRIPTION	REMARK
Q804	8-729-119-78	TRANSISTOR 2SC2785-HFE		✕R852 Δ.		METAL	1/4W
Q805	8-729-119-78	TRANSISTOR 2SC2785-HFE		R853	1-215-469-00	METAL	100K 1% 1/6W
Q806	8-729-119-80	TRANSISTOR 2SC2688-LK		R854	1-249-430-11	CARBON	12K 5% 1/4W
Q807	8-729-119-78	TRANSISTOR 2SC2785-HFE		R855	1-215-469-00	METAL	100K 1% 1/6W
Q808	8-729-119-78	TRANSISTOR 2SC2785-HFE		R856	1-249-430-11	CARBON	12K 5% 1/4W
				R857	1-249-433-11	CARBON	22K 5% 1/4W
Q809	8-729-119-76	TRANSISTOR 2SA1175-HFE		R858	1-260-095-91	CARBON	470 5% 1/2W
Q810	8-729-119-76	TRANSISTOR 2SA1175-HFE		R859	1-249-435-11	CARBON	33K 5% 1/4W
<RESISTOR>				R860	1-249-441-11	CARBON	100K 5% 1/4W
R517	1-249-418-11	CARBON	1.2K 5% 1/4W F	R862	1-249-434-11	CARBON	27K 5% 1/4W
R518	1-247-764-11	CARBON	10K 5% 1/2W	R863	1-249-431-11	CARBON	15K 5% 1/4W
R519	1-202-730-00	SOLID	8.2M 10% 1/2W	R864	1-249-428-11	CARBON	8.2K 5% 1/4W
R520	1-249-429-11	CARBON	10K 5% 1/4W	R865	1-249-440-11	CARBON	82K 5% 1/4W
R521	1-247-881-00	CARBON	120K 5% 1/4W	R866	1-249-436-11	CARBON	39K 5% 1/4W
R801	1-216-378-11	METAL OXIDE	5.6 5% 2W F	R867	1-249-437-11	CARBON	47K 5% 1/4W
R802	1-216-489-11	METAL OXIDE	27K 5% 3W F	R868	1-249-428-11	CARBON	8.2K 5% 1/4W
R803	1-216-489-11	METAL OXIDE	27K 5% 3W F	R869	1-249-429-11	CARBON	10K 5% 1/4W
R804	1-249-429-11	CARBON	10K 5% 1/4W	R870	1-260-099-91	CARBON	1K 5% 1/2W
R805	1-249-423-11	CARBON	3.3K 5% 1/4W	R871	1-249-468-11	CARBON	82K 5% 1/4W
R806	1-249-425-11	CARBON	4.7K 5% 1/4W	R879	1-216-489-11	METAL OXIDE	27K 5% 3W F
R807	1-260-123-91	CARBON	100K 5% 1/2W	R880	1-260-111-91	CARBON	10K 5% 1/2W
R808	1-249-417-11	CARBON	1K 5% 1/4W	R881	1-215-873-00	METAL OXIDE	4.7K 5% 1W F
R809	1-249-417-11	CARBON	1K 5% 1/4W	R882	1-215-473-00	METAL	150K 1% 1/6W
R810	1-249-441-11	CARBON	100K 5% 1/4W	R883	1-215-451-00	METAL	18K 1% 1/6W
R811	1-249-421-11	CARBON	2.2K 5% 1/4W	R884	1-249-401-11	CARBON	47 5% 1/4W
R812	1-249-420-11	CARBON	1.8K 5% 1/4W F	R890	1-249-423-11	CARBON	3.3K 5% 1/4W
R813	1-215-922-11	METAL OXIDE	6.8K 5% 3W F	R891	1-249-425-11	CARBON	4.7K 5% 1/4W
R816	1-214-777-00	METAL	100K 1% 1/4W	<SPARK GAP>			
R817	1-215-471-00	METAL	120K 1% 1/6W	SG1	1-519-422-11	GAP, SPARK	
R818	1-215-471-00	METAL	120K 1% 1/6W	<TRANSFORMER>			
R819	1-215-453-00	METAL	22K 1% 1/6W	T503	1-413-059-00	TRANSFORMER, FERRITE (DFT)	
R820	1-215-453-00	METAL	22K 1% 1/6W	T801	1-437-078-00	TRANSFORMER, HORIZONTAL DRIVE	
R821	1-249-423-11	CARBON	3.3K 5% 1/4W	T802	1-437-090-00	HBT	
R822	1-249-433-11	CARBON	22K 5% 1/4W	*****			
R823	1-249-429-11	CARBON	10K 5% 1/4W	*1-625-924-11	PC BOARD		
R824	1-215-469-00	METAL	100K 1% 1/6W	*****			
R825	1-214-761-00	METAL	22K 1% 1/4W	*4-341-751-01	EYELET		
✕R826 Δ.		METAL	1/4W	*4-341-752-01	EYELET		
✕R827 Δ.		METAL	1/4W	4-382-854-11	SCREW (M3X10), P. SW (+)		
R828	1-215-455-00	METAL	27K 1% 1/6W	<CAPACITOR>			
R829	1-215-476-00	METAL	200K 1% 1/6W	C1 Δ.1-136-723-11	FILM	0.02MF	3% 1.6KV
✕R830 Δ.		METAL	1/4W	C2 Δ.1-136-729-11	FILM	1.5MF	5% 400V
✕R831 Δ.		METAL	1/4W	C801 1-125-457-11	ELECT(BLOCK)	560MF	20% 200V
R832	1-249-417-11	CARBON	1K 5% 1/4W	<DIODE>			
R833	1-249-423-11	CARBON	3.3K 5% 1/4W	D1	8-719-945-80	DIODE ERC06-15S	
R834	1-249-423-11	CARBON	3.3K 5% 1/4W	<COIL>			
R835	1-215-429-00	METAL	2.2K 1% 1/6W	L1 Δ.1-424-401-11	COIL, CHOKE	1.05MMH	
R836	1-215-435-00	METAL	3.9K 1% 1/6W	L801 1-459-862-11	COIL, CHOKE	90UH	
R837	1-249-433-11	CARBON	22K 5% 1/4W	L802 1-424-401-11	COIL, CHOKE	1.05MMH	
R838	1-249-435-11	CARBON	33K 5% 1/4W	<NEON LAMP>			
R839	1-249-438-11	CARBON	56K 5% 1/4W				
R840	1-249-434-11	CARBON	27K 5% 1/4W				
R841	1-249-429-11	CARBON	10K 5% 1/4W				
R842	1-249-435-11	CARBON	33K 5% 1/4W				
R843	1-249-423-11	CARBON	3.3K 5% 1/4W				
R844	1-249-433-11	CARBON	22K 5% 1/4W				
R845	1-249-435-11	CARBON	33K 5% 1/4W				
R846	1-249-429-11	CARBON	10K 5% 1/4W				
R847	1-215-873-00	METAL OXIDE	4.7K 5% 1W F				
R848	1-215-431-00	METAL	2.7K 1% 1/6W				
R849	1-215-431-00	METAL	2.7K 1% 1/6W				
R850	1-214-741-00	METAL	3.3K 1% 1/4W				
R851	1-214-747-00	METAL	5.6K 1% 1/4W				

REF.NO.	PART NO.	DESCRIPTION	REMARK	REF.NO.	PART NO.	DESCRIPTION	REMARK
NL1	1-519-108-99	LAMP, NEON ASSY		C022	1-124-791-11	ELECT 1MF 20% 50V	
		<TRANSISTOR>		C023	1-124-791-11	ELECT 1MF 20% 50V	
Q1	A-8-729-805-07	TRANSISTOR 2SD1887-CA		C024	1-124-791-11	ELECT 1MF 20% 50V	
		<RESISTOR>		C025	1-124-477-11	ELECT 47MF 20% 16V	
R1	1-247-696-11	CARBON 47 5% 1/4W		C026	1-102-978-00	CERAMIC 220PF 5% 50V	
		<TRANSFORMER>		C027	1-124-477-11	ELECT 47MF 20% 16V	
T1	A-1-439-408-21	TRANSFORMER ASSY. FLYBACK(NX-2022)		C035	1-102-978-00	CERAMIC 220PF 5% 50V	
T2	A-1-439-408-21	TRANSFORMER ASSY. FLYBACK(NX-2012)		C036	1-101-006-00	CERAMIC 0.047MF 50V	
		*****		C037	1-130-497-00	MYLAR 0.15MF 5% 50V	
		*1-627-633-11 F BOARD		C038	1-101-004-00	CERAMIC 0.01MF 50V	
		*****		C039	1-101-004-00	CERAMIC 0.01MF 50V	
		*1-508-765-00 PIN, CONNECTOR (5MM PITCH) 3P		C040	1-102-963-00	CERAMIC 33PF 5% 50V	
		<RESISTOR>		C041	1-102-978-00	CERAMIC 220PF 5% 50V	
R2001	A1-205-712-11	WIREWOUND 3.9 5% 20W		C042	1-106-363-00	MYLAR 0.0068MF 10% 100V	
R2002	A1-205-712-11	WIREWOUND 3.9 5% 20W		C043	1-123-875-11	ELECT 10MF 20% 50V	
		*****		C101	1-123-875-11	ELECT 10MF 20% 50V	
		*A-1296-731-A A BOARD, COMPLETE		C102	1-124-477-11	ELECT 47MF 20% 16V	
		*****		C103	1-126-101-11	ELECT 100MF 20% 16V	
		1-506-348-99 PIN, CONNECTOR 3P		C104	1-126-233-11	ELECT 22MF 20% 25V	
		*1-508-765-00 PIN, CONNECTOR (5MM PITCH) 3P		C105	1-101-003-00	CERAMIC 0.0047MF 50V	
		*1-508-766-00 PIN, CONNECTOR (5MM PITCH) 4P		C106	1-101-003-00	CERAMIC 0.0047MF 50V	
		*1-508-786-00 PIN, CONNECTOR (5MM PITCH) 2P		C107	1-102-121-00	CERAMIC 0.0022MF 10% 50V	
		*1-533-146-00 HOLDER, FUSE		C108	1-123-875-11	ELECT 10MF 20% 50V	
		*1-564-506-11 PLUG, CONNECTOR 3P		C109	1-102-074-00	CERAMIC 0.001MF 10% 50V	
		*1-564-507-11 PLUG, CONNECTOR 4P		C110	1-124-046-00	ELECT 10MF 20% 160V	
		*1-564-509-11 PLUG, CONNECTOR 6P		C111	1-124-557-11	ELECT 1000MF 20% 25V	
		*1-564-510-11 PLUG, CONNECTOR 7P		C112	1-126-101-11	ELECT 100MF 20% 16V	
		*1-564-511-11 PLUG, CONNECTOR 8P		C113	1-124-477-11	ELECT 47MF 20% 16V	
		*1-564-512-11 PLUG, CONNECTOR 9P		C114	1-126-101-11	ELECT 100MF 20% 16V	
		*1-564-515-11 PLUG, CONNECTOR 12P		C116	1-126-101-11	ELECT 100MF 20% 16V	
		*4-028-047-01 HEAT SINK, CLIP TYPE		C121	1-124-557-11	ELECT 1000MF 20% 25V	
		*4-341-751-01 EYELET		C130	1-124-360-00	ELECT 1000MF 20% 16V	
		*4-341-752-01 EYELET		C202	1-102-973-00	CERAMIC 100PF 5% 50V	
		4-383-022-01 SPACER, MICA		C203	1-124-791-11	ELECT 1MF 20% 50V	
		<CAPACITOR>		C204	1-124-477-11	ELECT 47MF 20% 16V	
C001	1-102-961-00	CERAMIC 27PF 5% 50V		C205	1-124-791-11	ELECT 1MF 20% 50V	
C002	1-102-965-00	CERAMIC 39PF 5% 50V		C206	1-124-927-11	ELECT 4.7MF 20% 50V	
C003	1-102-125-00	CERAMIC 0.0047MF 10% 50V		C207	1-123-875-11	ELECT 10MF 20% 50V	
C004	1-102-125-00	CERAMIC 0.0047MF 10% 50V		C208	1-106-385-00	MYLAR 0.056MF 10% 100V	
C006	1-102-973-00	CERAMIC 100PF 5% 50V		C209	1-106-363-00	MYLAR 0.0068MF 10% 100V	
C007	1-101-004-00	CERAMIC 0.01MF 50V		C210	1-124-791-11	ELECT 1MF 20% 50V	
C008	1-101-880-00	CERAMIC 47PF 5% 50V		C211	1-106-363-00	MYLAR 0.0068MF 10% 100V	
C009	1-101-880-00	CERAMIC 47PF 5% 50V		C212	1-123-875-11	ELECT 10MF 20% 50V	
C010	1-126-101-11	ELECT 100MF 20% 16V		C213	1-124-902-00	ELECT 0.47MF 20% 50V	
C011	1-130-487-00	MYLAR 0.022MF 5% 50V		C214	1-130-483-00	MYLAR 0.01MF 5% 50V	
C012	1-124-477-11	ELECT 47MF 20% 16V		C215	1-124-902-00	ELECT 0.47MF 20% 50V	
C013	1-119-160-00	ELECT 470MF 10V		C216	1-124-902-00	ELECT 0.47MF 20% 50V	
C020	1-123-875-11	ELECT 10MF 20% 50V		C217	1-126-101-11	ELECT 100MF 20% 16V	
C021	1-124-927-11	ELECT 4.7MF 20% 50V		C218	1-130-483-00	MYLAR 0.01MF 5% 50V	
				C219	1-124-477-11	ELECT 47MF 20% 16V	
				C220	1-101-884-00	CERAMIC 56PF 5% 50V	
				C221	1-102-961-00	CERAMIC 27PF 5% 50V	
				C222	1-102-951-00	CERAMIC 15PF 5% 50V	
				C224	1-102-038-00	CERAMIC 0.001MF 500V	
				C225	1-130-493-00	MYLAR 0.068MF 5% 50V	
				C226	1-124-791-11	ELECT 1MF 20% 50V	
				C227	1-130-489-00	MYLAR 0.033MF 5% 50V	
				C228	1-124-925-11	ELECT 2.2MF 20% 50V	
				C229	1-130-487-00	MYLAR 0.022MF 5% 50V	
				C230	1-130-483-00	MYLAR 0.01MF 5% 50V	
				C231	1-124-464-11	ELECT 0.22MF 20% 50V	
				C233	1-124-119-00	ELECT 330MF 20% 16V	
				C234	1-124-902-00	ELECT 0.47MF 20% 50V	

REF.NO.	PART NO.	DESCRIPTION	REMARK	REF.NO.	PART NO.	DESCRIPTION	REMARK				
C235	1-106-359-00	MYLAR	0.0047MF	5%	50V	C669	1-126-101-11	ELECT	100MF	20%	16V
C236	1-102-947-00	CERAMIC	10PF	0.5PF	50V	C670	1-124-477-11	ELECT	47MF	20%	16V
C237	1-126-320-11	ELECT	10MF	20%	16V	C901	1-124-607-11	ELECT	2200MF	20%	50V
C238	1-124-464-11	ELECT	0.22MF	20%	50V	C902	1-124-122-11	ELECT	100MF	20%	50V
C239	1-126-233-11	ELECT	22MF	20%	25V	C903	1-124-122-11	ELECT	100MF	20%	50V
C241	1-123-875-11	ELECT	10MF	20%	50V	C904	1-124-618-11	ELECT	2200MF	20%	35V
C290	1-130-487-00	MYLAR	0.022MF	5%	50V	C905	1-124-910-11	ELECT	47MF	20%	50V
C291	1-124-791-11	ELECT	1MF	20%	50V	C906	1-130-495-00	MYLAR	0.1MF	5%	50V
C292	1-130-483-00	MYLAR	0.01MF	5%	50V	C907	1-130-499-00	MYLAR	0.22MF	5%	50V
C293	1-124-791-11	ELECT	1MF	20%	50V	C908	1-124-122-11	ELECT	100MF	20%	50V
C300	1-106-359-00	MYLAR	0.0047MF	5%	50V	C909	1-124-902-00	ELECT	0.47MF	20%	50V
C502	1-126-101-11	ELECT	100MF	20%	16V	C910	1-102-824-00	CERAMIC	470PF	5%	50V
C503	1-126-101-11	ELECT	100MF	20%	16V	C911	1-124-910-11	ELECT	47MF	20%	50V
C504	1-136-722-11	FILM	0.008MF	3%	1.6KV	C912	1-124-618-11	ELECT	2200MF	20%	35V
C505	1-106-383-00	MYLAR	0.047MF		200V	C913	1-130-495-00	MYLAR	0.1MF	5%	50V
C506	1-102-030-00	CERAMIC	330PF	10%	500V	C914	1-130-499-00	MYLAR	0.22MF	5%	50V
C507	1-102-973-00	CERAMIC	100PF	5%	50V	C915	1-124-122-11	ELECT	100MF	20%	50V
C508	1-124-902-00	ELECT	0.47MF	20%	50V	C916	1-124-902-00	ELECT	0.47MF	20%	50V
C509	1-136-113-11	FILM	2MF	5%	200V	C917	1-102-824-00	CERAMIC	470PF	5%	50V
C510	1-136-113-11	FILM	2MF	5%	200V	C918	1-124-477-11	ELECT	47MF	20%	16V
C511	1-123-935-00	ELECT	33MF	20%	160V	C919	1-124-477-11	ELECT	47MF	20%	16V
C512	1-130-487-00	MYLAR	0.022MF	5%	50V	C920	1-124-477-11	ELECT	47MF	20%	16V
C513	1-106-383-00	MYLAR	0.047MF		200V	C921	1-124-477-11	ELECT	47MF	20%	16V
C514	1-130-483-00	MYLAR	0.01MF	5%	50V	C922	1-124-119-00	ELECT	330MF	20%	16V
C515	1-124-477-11	ELECT	47MF	20%	16V	C923	1-126-101-11	ELECT	100MF	20%	16V
C518	1-124-662-11	ELECT	220MF	20%	50V	C924	1-124-119-00	ELECT	330MF	20%	16V
C519	1-124-662-11	ELECT	220MF	20%	50V	<COMPOSITION CIRCUIT BLOCK>					
C520	1-124-662-11	ELECT	220MF	20%	50V	CP001	1-232-172-11	COMPOSITION CIRCUIT BLOCK			
C551	1-130-487-00	MYLAR	0.022MF	5%	50V	CP002	1-233-161-11	COMPOSITION CIRCUIT BLOCK			
C552	1-126-101-11	ELECT	100MF	20%	16V	CP003	1-233-161-11	COMPOSITION CIRCUIT BLOCK			
C553	1-130-483-00	MYLAR	0.01MF	5%	50V	CP004	1-232-171-11	COMPOSITION CIRCUIT BLOCK			
C554	1-102-824-00	CERAMIC	470PF	5%	50V	CP005	1-232-182-11	COMPOSITION CIRCUIT BLOCK			
C555	1-130-483-00	MYLAR	0.01MF	5%	50V	CP006	1-231-682-00	COMPOSITION CIRCUIT BLOCK			
C556	1-124-477-11	ELECT	47MF	20%	16V	CP007	1-232-028-00	COMPOSITION CIRCUIT BLOCK			
C557	1-124-477-11	ELECT	47MF	20%	16V	CP008	1-232-257-00	COMPOSITION CIRCUIT BLOCK			
C558	1-130-483-00	MYLAR	0.01MF	5%	50V	CP009	1-232-400-11	COMPOSITION CIRCUIT BLOCK			
C559	1-102-824-00	CERAMIC	470PF	5%	50V	<DIODE>					
C560	1-130-483-00	MYLAR	0.01MF	5%	50V	D001	8-719-911-19	DIODE 1SS119			
C561	1-102-824-00	CERAMIC	470PF	5%	50V	D010	8-719-109-68	DIODE RD3.6ES-B1			
C562	1-130-483-00	MYLAR	0.01MF	5%	50V	D012	8-719-911-19	DIODE 1SS119			
C563	1-102-824-00	CERAMIC	470PF	5%	50V	D101	8-719-110-76	DIODE RD33ES-B1			
C564	1-130-487-00	MYLAR	0.022MF	5%	50V	D201	8-719-911-19	DIODE 1SS119			
C565	1-126-101-11	ELECT	100MF	20%	16V	D202	8-719-109-66	DIODE RD3.3ES-B2			
C566	1-102-824-00	CERAMIC	470PF	5%	50V	D203	8-719-911-19	DIODE 1SS119			
C567	1-102-824-00	CERAMIC	470PF	5%	50V	D204	8-719-911-19	DIODE 1SS119			
C568	1-124-925-11	ELECT	2.2MF	20%	50V	D205	8-719-911-19	DIODE 1SS119			
C572	1-124-477-11	ELECT	47MF	20%	16V	D206	8-719-911-19	DIODE 1SS119			
C580	1-124-046-00	ELECT	10MF	20%	160V	D210	8-719-110-30	DIODE RD12ES-B1			
C651	1-136-311-51	FILM	0.47MF	20%	125V	D220	8-719-109-50	DIODE RD2.0ES-B1			
C653	1-161-743-12	CERAMIC	0.0047MF		400V	D290	8-719-911-19	DIODE 1SS119			
C654	1-161-743-12	CERAMIC	0.0047MF		400V	D501	8-719-300-80	DIODE RU-1C			
C655	1-136-311-51	FILM	0.47MF	20%	125V	D504	8-719-901-93	DIODE V19E			
C656	1-161-743-00	CERAMIC	0.0047MF		400V	D505	8-719-901-93	DIODE V19E			
C657	1-161-743-00	CERAMIC	0.0047MF		400V	D507	8-719-911-19	DIODE 1SS119			
C658	1-125-320-00	ELECT (BLOCK)	820MF		200V	D651	8-719-503-06	DIODE S3WB60Z			
C659	1-125-320-00	ELECT (BLOCK)	820MF		200V	D652	8-719-511-40	DIODE S1VB40			
C660	1-161-743-00	CERAMIC	0.0047MF		400V	D653	8-719-200-02	DIODE 10E2			
C661	1-106-383-00	MYLAR	0.047MF	10%	100V	D901	8-719-911-19	DIODE 1SS119			
C662	1-102-125-00	CERAMIC	0.0047MF	10%	50V	D902	8-719-911-19	DIODE 1SS119			
C663	1-102-125-00	CERAMIC	0.0047MF	10%	50V	D904	8-719-911-55	DIODE U05G			
C664	1-124-480-11	ELECT	470MF	20%	25V						
C665	1-124-119-00	ELECT	330MF	20%	16V						
C666	1-124-119-00	ELECT	330MF	20%	16V						
C667	1-124-119-00	ELECT	330MF	20%	16V						

REF. NO.	PART NO.	DESCRIPTION	REMARK	REF. NO.	PART NO.	DESCRIPTION	REMARK
D905	8-719-160-78	DIODE RD24F-B2		Q203	8-729-119-78	TRANSISTOR 2SC2785-HFE	
D906	8-719-110-39	DIODE RD15ES-B1		Q204	8-729-119-76	TRANSISTOR 2SA1175-HFE	
<FUSE>				Q205	8-729-119-76	TRANSISTOR 2SA1175-HFE	
F651A	1-532-748-11	FUSE, GLASS TUBE 6.3A/125V		Q206	8-729-119-78	TRANSISTOR 2SC2785-HFE	
<IC>				Q207	8-729-119-78	TRANSISTOR 2SC2785-HFE	
IC001	8-759-998-78	IC MB88E734-132		Q208	8-729-119-76	TRANSISTOR 2SA1175-HFE	
IC002	8-759-102-28	IC UPD6326C		Q209	8-729-119-78	TRANSISTOR 2SC2785-HFE	
IC101A	8-759-982-35	IC RC78M12FA		Q210	8-729-119-78	TRANSISTOR 2SC2785-HFE	
IC102A	8-759-982-37	IC RC78M93FD		Q211	8-729-119-78	TRANSISTOR 2SC2785-HFE	
IC103A	8-759-982-31	IC RC78M05FA		Q212	8-729-119-78	TRANSISTOR 2SC2785-HFE	
IC201	8-752-031-71	IC CXA1012AS		Q215	8-729-119-76	TRANSISTOR 2SA1175-HFE	
IC202	8-759-012-52	IC CX20125		Q216	8-729-119-78	TRANSISTOR 2SC2785-HFE	
IC551	8-759-945-58	IC RC4558P		Q217	8-729-119-78	TRANSISTOR 2SC2785-HFE	
IC552	8-759-945-58	IC RC4558P		Q221	8-729-119-78	TRANSISTOR 2SC2785-HFE	
IC553	8-759-945-58	IC RC4558P		Q222	8-729-119-76	TRANSISTOR 2SA1175-HFE	
IC651	8-759-982-26	IC RC78L12A		Q223	8-729-119-78	TRANSISTOR 2SC2785-HFE	
IC652	8-759-982-21	IC RC78L05A		Q224	8-729-119-76	TRANSISTOR 2SA1175-HFE	
IC901A	8-749-920-14	IC STK4412		Q225	8-729-119-78	TRANSISTOR 2SC2785-HFE	
MM901	8-741-156-80	IC SBX1568-51		Q226	8-729-119-76	TRANSISTOR 2SA1175-HFE	
<IF BLOCK>				Q501	8-729-800-80	TRANSISTOR 2SD1399-CA	
IF101	1-464-755-21	IF BLOCK (IFE-450A)		Q502	8-729-119-80	TRANSISTOR 2SC2688-LK	
<COIL>				Q503	8-729-386-12	TRANSISTOR 2SB861-C	
L001	1-408-421-00	INDUCTOR 100UH		Q504	8-729-304-92	TRANSISTOR 2SB649A-C	
L003	1-408-404-00	INDUCTOR 3.9UH		Q505	8-729-201-32	TRANSISTOR 2SA1013-0	
L004	1-408-404-00	INDUCTOR 3.9UH		Q506	8-729-201-32	TRANSISTOR 2SA1013-0	
L005	1-408-404-00	INDUCTOR 3.9UH		Q507	8-729-119-78	TRANSISTOR 2SC2785-HFE	
L006	1-408-404-00	INDUCTOR 3.9UH		Q508	8-729-900-89	TRANSISTOR DTC144ES	
L101	1-459-155-00	COIL (WITH CORE) 45UH		Q551	8-729-205-96	TRANSISTOR 2SC3668-0	
L102	1-408-421-00	INDUCTOR 100UH		Q552	8-729-205-95	TRANSISTOR 2SA1428-Y	
L103	1-408-408-00	INDUCTOR 8.2UH		Q553	8-729-205-96	TRANSISTOR 2SC3668-0	
L105	1-459-155-00	COIL (WITH CORE) 45UH		Q554	8-729-205-95	TRANSISTOR 2SA1428-Y	
L106	1-459-155-00	COIL (WITH CORE) 45UH		Q555	8-729-205-96	TRANSISTOR 2SC3668-0	
L201	1-410-472-41	INDUCTOR 15UH		Q556	8-729-205-95	TRANSISTOR 2SA1428-Y	
L202	1-410-466-41	INDUCTOR 4.7UH		Q651	8-729-378-84	TRANSISTOR 2SD788-5	
L204	1-408-429-00	INDUCTOR 470UH		Q903A	8-729-378-82	TRANSISTOR 2SD788-3	
L501	1-408-421-00	INDUCTOR 100UH		Q904	8-729-119-76	TRANSISTOR 2SA1175-HFE	
L503A	1-459-241-12	COIL, HORIZONTAL LINEALITY		Q905	8-729-926-40	TRANSISTOR XDC124ES	
L901	1-459-155-00	COIL (WITH CORE) 45UH		Q907	8-729-119-78	TRANSISTOR 2SC2785-HFE	
L902	1-459-155-00	COIL (WITH CORE) 45UH		Q908	8-729-119-76	TRANSISTOR 2SA1175-HFE	
<TRANSISTOR>				<RESISTOR>			
Q001	8-729-119-78	TRANSISTOR 2SC2785-HFE		R001	1-260-103-91	CARBON 2.2K 5%	1/2W
Q002	8-729-119-78	TRANSISTOR 2SC2785-HFE		R003	1-249-416-11	CARBON 820 5%	1/4W
Q003	8-729-119-78	TRANSISTOR 2SC2785-HFE		R004	1-249-416-11	CARBON 820 5%	1/4W
Q004	8-729-119-78	TRANSISTOR 2SC2785-HFE		R005	1-249-416-11	CARBON 820 5%	1/4W
Q005	8-729-119-78	TRANSISTOR 2SC2785-HFE		R006	1-249-431-11	CARBON 15K 5%	1/4W
Q006	8-729-119-78	TRANSISTOR 2SC2785-HFE		R007	1-260-111-91	CARBON 10K 5%	1/2W
Q007	8-729-119-76	TRANSISTOR 2SA1175-HFE		R008	1-249-421-11	CARBON 2.2K 5%	1/4W
Q016	8-729-119-76	TRANSISTOR 2SA1175-HFE		R009	1-249-412-11	CARBON 390 5%	1/4W
Q017	8-729-119-78	TRANSISTOR 2SC2785-HFE		R010	1-249-433-11	CARBON 22K 5%	1/4W
Q018	8-729-119-78	TRANSISTOR 2SC2785-HFE		R011	1-249-421-11	CARBON 2.2K 5%	1/4W
Q101	8-729-119-78	TRANSISTOR 2SC2785-HFE		R012	1-249-437-11	CARBON 47K 5%	1/4W
Q102	8-729-119-78	TRANSISTOR 2SC2785-HFE		R013	1-249-437-11	CARBON 47K 5%	1/4W
Q201	8-729-119-78	TRANSISTOR 2SC2785-HFE		R014	1-249-441-11	CARBON 100K 5%	1/4W
Q202	8-729-119-76	TRANSISTOR 2SA1175-HFE		R015	1-249-433-11	CARBON 22K 5%	1/4W
				R016	1-249-417-11	CARBON 1K 5%	1/4W
				R017	1-260-111-91	CARBON 10K 5%	1/2W
				R018	1-249-421-11	CARBON 2.2K 5%	1/4W
				R019	1-249-421-11	CARBON 2.2K 5%	1/4W
				R020	1-249-417-11	CARBON 1K 5%	1/4W
				R021	1-249-414-11	CARBON 560 5%	1/4W
				R022	1-249-409-11	CARBON 220 5%	1/4W

REF. NO.	PART NO.	DESCRIPTION			REMARK	REF. NO.	PART NO.	DESCRIPTION			REMARK
R023	1-249-409-11	CARBON	220	5%	1/4W	R111	1-249-417-11	CARBON	1K	5%	1/4W
R024	1-249-409-11	CARBON	220	5%	1/4W	R112	1-249-425-11	CARBON	4.7K	5%	1/4W
R025	1-249-417-11	CARBON	1K	5%	1/4W	R113	1-249-414-11	CARBON	560	5%	1/4W
R027	1-249-413-11	CARBON	470	5%	1/4W	R114	1-249-417-11	CARBON	1K	5%	1/4W
R028	1-249-413-11	CARBON	470	5%	1/4W	R115	1-249-417-11	CARBON	1K	5%	1/4W
R029	1-260-111-91	CARBON	10K	5%	1/2W	R116	1-215-883-11	METAL OXIDE	33	5%	2W F
R030	1-249-421-11	CARBON	2.2K	5%	1/4W	R117 A. 1-215-930-51 METAL OXIDE 10 5% 5W F					
R031	1-249-421-11	CARBON	2.2K	5%	1/4W	R118 A. 1-215-882-91 METAL OXIDE 22 5% 2W F					
R032	1-247-722-11	CARBON	5.6K	5%	1/4W	R119	1-249-401-11	CARBON	47	5%	1/4W
R033	1-249-423-11	CARBON	3.3K	5%	1/4W	R122 A. 1-212-934-61 FUSIBLE 1 5% 1/2W F					
R034	1-260-103-91	CARBON	2.2K	5%	1/2W	R201	1-249-425-11	CARBON	4.7K	5%	1/4W
R035	1-260-103-91	CARBON	2.2K	5%	1/2W	R202	1-260-101-91	CARBON	1.5K	5%	1/2W
R036	1-249-433-11	CARBON	22K	5%	1/4W	R203	1-249-410-11	CARBON	270	5%	1/4W
R037	1-249-433-11	CARBON	22K	5%	1/4W	R205	1-202-729-00	SOLID	6.8M	10%	1/2W
R038	1-249-423-11	CARBON	3.3K	5%	1/4W	R206	1-249-423-11	CARBON	3.3K	5%	1/4W
R039	1-249-429-11	CARBON	10K	5%	1/4W	R207	1-249-429-11	CARBON	10K	5%	1/4W
R040	1-249-417-11	CARBON	1K	5%	1/4W	R208	1-247-901-11	CARBON	820K	5%	1/4W
R041	1-249-417-11	CARBON	1K	5%	1/4W	R209	1-249-417-11	CARBON	1K	5%	1/4W
R042	1-249-417-11	CARBON	1K	5%	1/4W	R210	1-249-434-11	CARBON	27K	5%	1/4W
R043	1-249-429-11	CARBON	10K	5%	1/4W	R211	1-249-429-11	CARBON	10K	5%	1/4W
R044	1-249-429-11	CARBON	10K	5%	1/4W	R212	1-249-429-11	CARBON	10K	5%	1/4W
R045	1-249-434-11	CARBON	27K	5%	1/4W	R213	1-249-429-11	CARBON	10K	5%	1/4W
R046	1-249-411-11	CARBON	330	5%	1/4W	R214	1-249-417-11	CARBON	1K	5%	1/4W
R047	1-249-429-11	CARBON	10K	5%	1/4W	R215	1-249-417-11	CARBON	1K	5%	1/4W
R048	1-247-893-11	CARBON	390K	5%	1/4W	R216	1-249-429-11	CARBON	10K	5%	1/4W
R049	1-249-434-11	CARBON	27K	5%	1/4W	R217	1-247-897-11	CARBON	560K	5%	1/4W
R051	1-247-893-11	CARBON	390K	5%	1/4W	R218	1-247-895-00	CARBON	470K	5%	1/4W
R052	1-249-434-11	CARBON	27K	5%	1/4W	R219	1-249-427-11	CARBON	6.8K	5%	1/4W
R054	1-249-409-11	CARBON	220	5%	1/4W	R220	1-249-412-11	CARBON	390	5%	1/4W
R055	1-249-409-11	CARBON	220	5%	1/4W	R221	1-249-412-11	CARBON	390	5%	1/4W
R056	1-247-893-11	CARBON	390K	5%	1/4W	R222	1-249-411-11	CARBON	330	5%	1/4W
R057	1-249-434-11	CARBON	27K	5%	1/4W	R223	1-260-100-91	CARBON	1.2K	5%	1/2W
R059	1-249-409-11	CARBON	220	5%	1/4W	R224	1-247-899-11	CARBON	680K	5%	1/4W
R063	1-249-427-11	CARBON	6.8K	5%	1/4W	R225	1-249-418-11	CARBON	1.2K	5%	1/4W
R064	1-249-427-11	CARBON	6.8K	5%	1/4W	R226	1-249-422-11	CARBON	2.7K	5%	1/4W
R067	1-249-408-11	CARBON	180	5%	1/4W	R227	1-260-103-91	CARBON	2.2K	5%	1/2W
R068	1-249-409-11	CARBON	220	5%	1/4W	R228	1-260-089-91	CARBON	2.7K	5%	1/2W
R076	1-260-099-91	CARBON	1K	5%	1/2W	R229	1-249-414-11	CARBON	560	5%	1/4W
R077	1-249-421-11	CARBON	2.2K	5%	1/4W	R230	1-249-405-11	CARBON	100	5%	1/4W
R078	1-249-425-11	CARBON	4.7K	5%	1/4W	R231	1-249-412-11	CARBON	390	5%	1/4W
R079	1-249-414-11	CARBON	560	5%	1/4W	R233	1-260-103-91	CARBON	1K	5%	1/2W
R080	1-249-433-11	CARBON	22K	5%	1/4W	R235	1-249-438-11	CARBON	56K	5%	1/4W
R081	1-249-416-11	CARBON	820	5%	1/4W	R236	1-249-417-11	CARBON	1K	5%	1/4W
R084	1-260-095-91	CARBON	470	5%	1/2W	R237	1-249-417-11	CARBON	1K	5%	1/4W
R085	1-260-107-91	CARBON	4.7K	5%	1/2W	R238	1-249-417-11	CARBON	1K	5%	1/4W
R087	1-249-438-11	CARBON	56K	5%	1/4W	R239	1-249-421-11	CARBON	2.2K	5%	1/4W
R088	1-249-423-11	CARBON	3.3K	5%	1/4W	R240	1-249-425-11	CARBON	4.7K	5%	1/4W
R089	1-260-116-91	CARBON	27K	5%	1/2W	R241	1-249-430-11	CARBON	12K	5%	1/4W
R090	1-249-433-11	CARBON	22K	5%	1/4W	R242	1-249-436-11	CARBON	39K	5%	1/4W
R091	1-249-429-11	CARBON	10K	5%	1/4W	R243	1-249-421-11	CARBON	2.2K	5%	1/4W
R092	1-249-435-11	CARBON	33K	5%	1/4W	R244	1-260-103-91	CARBON	2.2K	5%	1/2W
R093	1-249-429-11	CARBON	10K	5%	1/4W	R245	1-249-414-11	CARBON	560	5%	1/4W
R094	1-249-417-11	CARBON	1K	5%	1/4W	R246	1-249-411-11	CARBON	330	5%	1/4W
R095	1-249-421-11	CARBON	2.2K	5%	1/4W	R247	1-249-411-11	CARBON	330	5%	1/4W
R101	1-260-108-91	CARBON	5.6K	5%	1/2W	R248	1-249-411-11	CARBON	330	5%	1/4W
R102	1-249-429-11	CARBON	10K	5%	1/4W	R249	1-260-103-91	METAL	180K	1%	1/2W
R103	1-260-099-91	CARBON	1K	5%	1/2W	R250	1-215-455-00	METAL	27K	1%	1/6W
R104	1-215-898-11	METAL OXIDE	10K	5%	2W F	R251	1-214-780-00	METAL	130K	1%	1/4W
R105	1-249-433-11	CARBON	22K	5%	1/4W	R252	1-249-436-11	CARBON	39K	5%	1/4W
R106	1-249-421-11	CARBON	2.2K	5%	1/4W	R253	1-249-421-11	CARBON	2.2K	5%	1/4W
R107	1-249-421-11	CARBON	2.2K	5%	1/4W	R254	1-249-427-11	CARBON	6.8K	5%	1/4W
R108	1-249-433-11	CARBON	22K	5%	1/4W	R255	1-249-424-11	CARBON	3.9K	5%	1/4W
R109	1-249-419-11	CARBON	1.5K	5%	1/4W	R256	1-260-089-91	CARBON	150	5%	1/2W
R110	1-249-439-11	CARBON	68K	5%	1/4W	R257	1-260-107-91	CARBON	4.7K	5%	1/2W

REF.NO.	PART NO.	DESCRIPTION	REMARK				REF.NO.	PART NO.	DESCRIPTION	REMARK			
R258	1-260-103-91	CARBON	2.2K	5%	1/2W		R555	1-215-375-00	METAL	12	1%	1/6W	
R259	1-249-422-11	CARBON	2.7K	5%	1/4W		R556	1-215-375-00	METAL	12	1%	1/6W	
R260	1-249-429-11	CARBON	10K	5%	1/4W		R557	1-215-445-00	METAL	10K	1%	1/6W	
R261	1-215-472-00	METAL	130K	1%	1/6W		R558	1-215-445-00	METAL	10K	1%	1/6W	
R262	1-249-423-11	CARBON	3.3K	5%	1/4W		R559	1-215-445-00	METAL	10K	1%	1/6W	
R263	1-216-482-11	METAL OXIDE	1.8K	5%	3W	F	R560	1-249-405-11	CARBON	100	5%	1/4W	
R264	1-216-482-11	METAL OXIDE	1.8K	5%	3W	F	R561	1-215-445-00	METAL	10K	1%	1/6W	
R265	1-249-413-11	CARBON	470	5%	1/4W		R562	1-215-423-00	METAL	1.2K	1%	1/6W	
R266	1-249-417-11	CARBON	1K	5%	1/4W		R563	1-215-375-00	METAL	12	1%	1/6W	
R267	1-249-418-11	CARBON	1.2K	5%	1/4W		R564	1-215-375-00	METAL	12	1%	1/6W	
R268	1-249-425-11	CARBON	4.7K	5%	1/4W		R565	1-215-375-00	METAL	12	1%	1/6W	
R269	1-249-413-11	CARBON	470	5%	1/4W		R566	1-215-445-00	METAL	10K	1%	1/6W	
R270	1-249-409-11	CARBON	220	5%	1/4W		R567	1-215-445-00	METAL	10K	1%	1/6W	
R271	1-249-417-11	CARBON	1K	5%	1/4W		R568	1-215-445-00	METAL	10K	1%	1/6W	
R273	1-260-111-91	CARBON	10K	5%	1/2W		R569	1-249-417-11	CARBON	1K	5%	1/4W	
R274	1-249-431-11	CARBON	15K	5%	1/4W		R570	1-215-423-00	METAL	1.2K	1%	1/6W	
R278	1-249-438-11	CARBON	56K	5%	1/4W		R571	1-215-375-00	METAL	12	1%	1/6W	
R279	1-216-482-11	METAL OXIDE	1.8K	5%	3W	F	R572	1-215-375-00	METAL	12	1%	1/6W	
R281	1-249-423-11	CARBON	3.3K	5%	1/4W		R573	1-215-375-00	METAL	12	1%	1/6W	
R282	1-249-434-11	CARBON	27K	5%	1/4W		R574	1-215-445-00	METAL	10K	1%	1/6W	
R283	1-249-425-11	CARBON	4.7K	5%	1/4W		R575	1-215-445-00	METAL	10K	1%	1/6W	
R284	1-260-099-91	CARBON	1K	5%	1/2W		R576	1-215-445-00	METAL	10K	1%	1/6W	
R285	1-260-099-91	CARBON	1K	5%	1/2W		R577	1-249-417-11	CARBON	1K	5%	1/4W	
R286	1-249-405-11	CARBON	100	5%	1/4W		R578	1-215-445-00	METAL	10K	1%	1/6W	
R288	1-249-424-11	CARBON	3.9K	5%	1/4W		R579	1-215-445-00	METAL	10K	1%	1/6W	
R289	1-216-482-11	METAL OXIDE	1.8K	5%	3W	F	R581	1-249-441-11	CARBON	100K	5%	1/4W	
R292	1-249-421-11	CARBON	2.2K	5%	1/4W		R582	1-260-099-91	CARBON	1K	5%	1/2W	
R293	1-249-423-11	CARBON	3.3K	5%	1/4W		R583	1-249-433-11	CARBON	22K	5%	1/4W	
R294	1-249-423-11	CARBON	3.3K	5%	1/4W		R585	1-249-425-11	CARBON	4.7K	5%	1/4W	
R295	1-249-423-11	CARBON	3.3K	5%	1/4W		R588	1-249-429-11	CARBON	10K	5%	1/4W	
R297	1-249-429-11	CARBON	10K	5%	1/4W		R589	1-249-432-11	CARBON	18K	5%	1/4W	
R301	1-249-429-11	CARBON	10K	5%	1/4W		R591	1-260-087-91	CARBON	100	5%	1/2W	
R330	1-249-411-11	CARBON	330	5%	1/4W		R592	1-249-405-11	CARBON	100	5%	1/4W	
R332	1-249-417-11	CARBON	1K	5%	1/4W		R593	1-249-417-11	CARBON	1K	5%	1/4W	
R333	1-249-421-11	CARBON	2.2K	5%	1/4W		R594						
R334	1-249-411-11	CARBON	330	5%	1/4W		R595						
R335	1-249-421-11	CARBON	2.2K	5%	1/4W		R596						
R336	1-249-411-11	CARBON	330	5%	1/4W		R597						
R337	1-249-421-11	CARBON	2.2K	5%	1/4W		R598						
R338	1-249-411-11	CARBON	330	5%	1/4W		R599						
R339	1-249-419-11	CARBON	1.5K	5%	1/4W		R600						
R340	1-249-418-11	CARBON	1.2K	5%	1/4W		R601						
R399	1-249-415-11	CARBON	680	5%	1/4W		R602						
R502	1-215-821-91	METAL OXIDE	680	5%	1W	F	R603						
R503	1-216-446-00	METAL OXIDE	18	5%	2W	F	R604						
R504	1-215-868-00	METAL OXIDE	680	5%	1W	F	R605						
R505	1-249-429-11	CARBON	10K	5%	1/4W	F	R606						
R506	1-249-423-11	CARBON	3.3K	5%	1/4W		R607						
R508	1-249-434-11	CARBON	27K	5%	1/4W		R608						
R510	1-249-417-91	CARBON	1K	5%	1/4W	F	R609						
R511	1-247-831-91	CARBON	1K	5%	1/4W		R610						
R513	1-260-099-91	CARBON	1K	5%	1/2W		R611						
R514	1-247-895-00	CARBON	470K	5%	1/4W		R612						
R515	1-249-421-11	CARBON	2.2K	5%	1/4W		R613						
R516	1-249-422-11	CARBON	2.7K	5%	1/4W		R614						
R522	1-249-411-11	CARBON	330	5%	1/4W		R615						
R525	1-249-385-11	CARBON	2.2	5%	1/4W	F	R616						
R526	1-249-385-11	CARBON	2.2	5%	1/4W	F	R617						
R527	1-249-385-11	CARBON	2.2	5%	1/4W	F	R618						
R551	1-249-405-11	CARBON	100	5%	1/4W		R619						
R552	1-215-423-00	METAL	1.2K	1%	1/6W		R620						
R553	1-249-417-11	CARBON	1K	5%	1/4W								
R554	1-215-375-00	METAL	12	1%	1/6W								
R654	1-215-904-11	METAL OXIDE	100K	5%	2W	F							
R655	1-215-904-11	METAL OXIDE	100K	5%	2W	F							
R657	1-249-417-11	CARBON	1K	5%	1/4W	F							
R658	1-215-865-11	METAL OXIDE	220	5%	1W	F							
R659	1-249-421-11	CARBON	2.2K	5%	1/4W								
R901	1-249-887-91	CARBON	100	5%	1/4W								
R902	1-247-887-00	CARBON	220K	5%	1/4W								
R903	1-249-441-11	CARBON	100K	5%	1/4W								
R904	1-249-441-11	CARBON	100K	5%	1/4W								
R905	1-249-433-11	CARBON	22K	5%	1/4W								
R906	1-249-441-11	CARBON	100K	5%	1/4W								
R907	1-249-433-11	CARBON	22K	5%	1/4W								
R908	1-249-407-11	CARBON	150	5%	1/4W								
R909	1-249-426-11	CARBON	5.6K	5%	1/4W								
R910	1-249-422-11	CARBON	2.7K	5%	1/4W								
R911	1-249-389-11	CARBON	4.7	5%	1/4W								
R912	1-249-426-11	CARBON	5.6K	5%	1/4W								
R913	1-249-422-11	CARBON	2.7K	5%	1/4W								
R914	1-249-407-11	CARBON	150	5%	1/4W								
R915	1-249-389-11	CARBON	4.7	5%	1/4W								
R916	1-249-411-11	CARBON	330	5%	1/4W								
R917	1-249-413-11	CARBON	470	5%	1/4W								
R918	1-260-093-91	CARBON	330	5%	1/2W								
R919	1-249-411-11	CARBON	330	5%	1/4W								
R920	1-249-411-11	CARBON	330	5%	1/4W								

REF.NO.	PART NO.	DESCRIPTION	REMARK
R921	1-249-441-11	CARBON 100K 5%	1/4W
R922	1-249-418-11	CARBON 1.2K 5%	1/4W
R923	1-215-916-00	METAL OXIDE 680 5%	3W F
R924	1-215-888-00	METAL OXIDE 220 5%	2W F
R925	1-215-888-00	METAL OXIDE 220 5%	2W F
R926	1-202-838-00	SOLID 100K 10%	1/2W
R927	1-249-437-11	CARBON 47K 5%	1/4W
R928	1-249-441-11	CARBON 100K 5%	1/4W
R929	1-249-429-11	CARBON 10K 5%	1/4W
R931	1-249-441-11	CARBON 100K 5%	1/4W
R932	1-216-351-00	METAL OXIDE 1.5 5%	1W F
R933	1-249-413-11	CARBON 470 5%	1/4W
<VARIABLE RESISTOR>			
RV101	1-238-015-11	RES, ADJ, CARBON 4.7K	
RV102	1-238-011-11	RES, ADJ, CARBON 470	
RV201	1-238-011-11	RES, ADJ, CARBON 470	
RV202	1-238-016-11	RES, ADJ, CARBON 10K	
RV203	1-238-020-11	RES, ADJ, CARBON 100K	
RV204	1-238-020-11	RES, ADJ, CARBON 100K	
RV205	1-238-013-11	RES, ADJ, CARBON 2.2K	
RV206	1-238-013-11	RES, ADJ, CARBON 2.2K	
RV901	1-238-016-11	RES, ADJ, CARBON 10K	
RV902	1-238-016-11	RES, ADJ, CARBON 10K	
<RELAY>			
RY901	1-515-533-11	RELAY	
<TRANSFORMER>			
T001	1-404-538-11	COIL	
T502	1-437-078-00	TRANSFORMER, HORIZONTAL DRIVE	
<TUNER>			
<CRYSTAL>			
X001	1-567-192-11	OSCILLATOR, CERAMIC	
X201	1-567-505-11	OSCILLATOR, CRYSTAL	

*A-1331-069-A	CR BOARD, COMPLETE		

*1-508-765-00	PIN, CONNECTOR (5MM PITCH) 3P		
*1-508-784-00	PIN, CONNECTOR (5MM PITCH) 1P		
1-526-812-11	SOCKET, PICTURE TUBE		
1-556-880-81	LEAD ASSY, HIGH-VOLTAGE		
*1-564-508-11	PLUG, CONNECTOR 5P		
*1-564-509-11	PLUG, CONNECTOR 6P		
4-373-933-01	SHEET (TRANSISTOR), BN		
<CAPACITOR>			
C701	1-101-006-00	CERAMIC 0.047MF	50V

REF.NO.	PART NO.	DESCRIPTION				REMARK
C702	1-136-165-00	FILM	0.1MF	5%	50V	
C705	1-102-050-00	CERAMIC	0.01MF		500V	
C706	1-162-115-00	CERAMIC	330PF	10%	2KV	
C707	1-162-115-00	CERAMIC	330PF	10%	2KV	
C708	1-130-479-00	MYLAR	0.0047MF	5%	50V	
C709	1-101-006-00	CERAMIC	0.047MF		50V	
<DIODE>						
D701	8-719-911-19	DIODE	1SS119			
D702	8-719-911-19	DIODE	1SS119			
D703	8-719-911-19	DIODE	1SS119			
D704	8-719-911-19	DIODE	1SS119			
D705	8-719-911-19	DIODE	1SS119			
D706	8-719-911-19	DIODE	1SS119			
D707	8-719-110-36	DIODE	RD13ES-B2			
<COIL>						
L701	1-408-159-00	COIL, SPOOK CHOKE	3.3UH			
L702	1-408-159-00	COIL, SPOOK CHOKE	3.3UH			
L703	1-408-429-00	INDUCTOR	470UH			
L704	1-408-413-00	INDUCTOR	22UH			
<NEON LAMP>						
NL701	1-519-108-99	LAMP, NEON				
NL702	1-519-108-99	LAMP, NEON				
<TRANSISTOR>						
Q701	8-729-119-80	TRANSISTOR	2SC2688-LK			
Q702	8-729-255-12	TRANSISTOR	2SC2551-0			
Q703	8-729-200-17	TRANSISTOR	2SA1091-0			
Q704	8-729-200-17	TRANSISTOR	2SA1091-0			
<RESISTOR>						
R701	1-249-405-11	CARBON	100	5%	1/4W F	
R704	1-215-927-00	METAL OXIDE	47K	5%	3W F	
R705	1-215-431-00	METAL	2.7K	1%	1/6W	
R706	1-216-510-11	METAL OXIDE	8.2K	5%	5W F	
	*4-341-751-01	EYELET; R706				
R707	1-247-700-11	CARBON	100	5%	1/4W F	
R708	1-202-561-00	SOLID	330	10%	1/2W	
R709	1-202-828-11	SOLID	6.8K	10%	1/2W	
R710	1-202-842-11	SOLID	220K	10%	1/2W	
R711	1-202-847-00	SOLID	560K	10%	1/2W	
R712	1-202-814-11	SOLID	33K	10%	1/2W	
R714	1-202-818-00	SOLID	1K	10%	1/2W	
<SPARK GAP>						
SG701	1-519-063-99	DISCHARGING GAP				
SG702	1-519-063-99	DISCHARGING GAP				

*A-1331-070-A		CG BOARD, COMPLETE				

REF.NO.	PART NO.	DESCRIPTION	REMARK
*1-508-765-00	PIN, CONNECTOR (5MM PITCH) 3P		
*1-508-784-00	PIN, CONNECTOR (5MM PITCH) 1P		
1-526-812-11	SOCKET, PICTURE TUBE		
1-556-880-81	LEAD ASSY, HIGH-VOLTAGE		
*1-564-508-11	PLUG, CONNECTOR 5P		
*1-564-509-11	PLUG, CONNECTOR 6P		
4-373-933-01	SHEET (TRANSISTOR), BN		
<CAPACITOR>			
C721	1-101-006-00 CERAMIC	0.047MF	50V
C722	1-136-165-00 FILM	0.1MF 5%	50V
C725	1-102-050-00 CERAMIC	0.01MF	500V
C726	1-162-115-00 CERAMIC	330PF 10%	2KV
C727	1-162-115-00 CERAMIC	330PF 10%	2KV
C728	1-130-479-00 MYLAR	0.0047MF 5%	50V
C729	1-101-006-00 CERAMIC	0.047MF	50V
<DIODE>			
D721	8-719-911-19 DIODE 1SS119		
D722	8-719-911-19 DIODE 1SS119		
D723	8-719-911-19 DIODE 1SS119		
D724	8-719-911-19 DIODE 1SS119		
D725	8-719-911-19 DIODE 1SS119		
D726	8-719-911-19 DIODE 1SS119		
D727	8-719-110-36 DIODE RD13ES-B2		
<COIL>			
L721	1-408-159-00 COIL, SPOOK CHOKE 3.3UH		
L722	1-408-159-00 COIL, SPOOK CHOKE 3.3UH		
L723	1-408-429-00 INDUCTOR 470UH		
L724	1-408-413-00 INDUCTOR 22UH		
<NEON LAMP>			
NL721	1-519-108-99 LAMP, NEON		
NL722	1-519-108-99 LAMP, NEON		
<TRANSISTOR>			
Q721	8-729-119-80 TRANSISTOR 2SC2688-LK		
Q722	8-729-255-12 TRANSISTOR 2SC2551-0		
Q723	8-729-200-17 TRANSISTOR 2SA1091-0		
Q724	8-729-200-17 TRANSISTOR 2SA1091-0		
<RESISTOR>			
R721	1-249-405-11 CARBON	100 5% 1/4W	F
R724	1-215-927-00 METAL OXIDE	47K 5% 3W	F
R725	1-215-431-00 METAL	2.7K 1% 1/6W	F
R726	1-216-510-11 METAL OXIDE	8.2K 5% 5W	F
*4-341-751-01	EYELET; R726		
R727	1-247-700-11 CARBON	100 5% 1/4W	F
R728	1-202-561-00 SOLID	330 10% 1/2W	
R729	1-202-828-11 SOLID	6.8K 10% 1/2W	
R730	1-202-842-11 SOLID	220K 10% 1/2W	
R731	1-202-847-00 SOLID	560K 10% 1/2W	
R732	1-202-814-11 SOLID	33K 10% 1/2W	
R734	1-202-818-00 SOLID	1K 10% 1/2W	

REF.NO.	PART NO.	DESCRIPTION	REMARK
<SPARK GAP>			
SG721	1-519-063-99	DISCHARGING GAP	
SG722	1-519-063-99	DISCHARGING GAP	

*A-1331-071-A	CB BOARD, COMPLETE		

*1-508-765-00	PIN, CONNECTOR (5MM PITCH) 3P		
*1-508-784-00	PIN, CONNECTOR (5MM PITCH) 1P		
1-526-812-11	SOCKET, PICTURE TUBE		
1-556-880-81	LEAD ASSY, HIGH-VOLTAGE		
*1-564-508-11	PLUG, CONNECTOR 5P		
*1-564-509-11	PLUG, CONNECTOR 6P		
4-373-933-01	SHEET (TRANSISTOR), BN		
<CAPACITOR>			
C741	1-101-006-00 CERAMIC	0.047MF	50V
C742	1-136-165-00 FILM	0.1MF 5%	50V
C745	1-102-050-00 CERAMIC	0.01MF	500V
C746	1-162-115-00 CERAMIC	330PF 10%	2KV
C747	1-162-115-00 CERAMIC	330PF 10%	2KV
C748	1-130-479-00 MYLAR	0.0047MF 5%	50V
C749	1-101-006-00 CERAMIC	0.047MF	50V
<DIODE>			
D741	8-719-911-19 DIODE 1SS119		
D742	8-719-911-19 DIODE 1SS119		
D743	8-719-911-19 DIODE 1SS119		
D744	8-719-911-19 DIODE 1SS119		
D745	8-719-911-19 DIODE 1SS119		
D746	8-719-911-19 DIODE 1SS119		
D747	8-719-110-36 DIODE RD13ES-B2		
<COIL>			
L741	1-408-159-00 COIL, SPOOK CHOKE 3.3UH		
L742	1-408-159-00 COIL, SPOOK CHOKE 3.3UH		
L743	1-408-429-00 INDUCTOR 470UH		
L744	1-408-413-00 INDUCTOR 22UH		
<NEON LAMP>			
NL741	1-519-108-99 LAMP, NEON		
NL742	1-519-108-99 LAMP, NEON		
<TRANSISTOR>			
Q741	8-729-119-80 TRANSISTOR 2SC2688-LK		
Q742	8-729-255-12 TRANSISTOR 2SC2551-0		
Q743	8-729-200-17 TRANSISTOR 2SA1091-0		
Q744	8-729-200-17 TRANSISTOR 2SA1091-0		
<RESISTOR>			
R741	1-249-405-11 CARBON	100 5% 1/4W	F
R744	1-215-927-00 METAL OXIDE	47K 5% 3W	F
R745	1-215-431-00 METAL	2.7K 1% 1/6W	F
R746	1-216-510-11 METAL OXIDE	8.2K 5% 5W	F

REF.NO.	PART NO.	DESCRIPTION	REMARK
	*4-341-751-01	EYELET; R746	
R747	1-247-700-11	CARBON	100 5% 1/4W F
R748	1-202-561-00	SOLID	330 10% 1/2W
R749	1-202-828-11	SOLID	6.8K 10% 1/2W
R750	1-202-842-11	SOLID	220K 10% 1/2W
R751	1-202-847-00	SOLID	560K 10% 1/2W
R752	1-202-814-11	SOLID	33K 10% 1/2W
R754	1-202-818-00	SOLID	1K 10% 1/2W

<SPARK GAP>

SG741	1-519-063-99	DISCHARGING GAP
SG742	1-519-063-99	DISCHARGING GAP

*A-1341-370-A D BOARD, COMPLETE

*1-508-784-00	PIN, CONNECTOR (5MM PITCH) 1P
*1-564-506-11	PLUG, CONNECTOR 3P
*1-564-507-11	PLUG, CONNECTOR 4P
*1-564-508-11	PLUG, CONNECTOR 5P
*1-564-509-11	PLUG, CONNECTOR 6P
*1-564-510-11	PLUG, CONNECTOR 7P
*1-564-511-11	PLUG, CONNECTOR 8P
*4-381-904-01	SPRING (C)

<CAPACITOR>

C301	1-101-810-00	CERAMIC	100PF	5%	500V
C303	1-124-046-00	ELECT	10MF	20%	160V
C304	1-106-367-00	MYLAR	0.01MF	10%	200V
C305	1-102-244-00	CERAMIC	220PF	10%	500V
C306	1-106-367-00	MYLAR	0.01MF	10%	200V
C307	1-101-810-00	CERAMIC	100PF	5%	500V
C308	1-124-798-11	ELECT	1MF	20%	160V
C309	1-124-477-11	ELECT	47MF	20%	16V
C310	1-130-483-00	MYLAR	0.01MF	5%	50V
C311	1-130-495-00	MYLAR	0.1MF	5%	50V
C312	1-102-976-00	CERAMIC	180PF	5%	50V
C313	1-102-980-00	CERAMIC	270PF	5%	50V
C314	1-130-475-00	MYLAR	0.0022MF	5%	50V
C315	1-124-477-11	ELECT	47MF	20%	16V
C316	1-124-120-11	ELECT	220MF	20%	16V
C318	1-123-935-00	ELECT	33MF	20%	160V
C319	1-102-978-00	CERAMIC	220PF	5%	50V
C320	1-102-824-00	CERAMIC	470PF	5%	50V
C321	1-102-824-00	CERAMIC	470PF	5%	50V
C322	1-101-361-00	CERAMIC	150PF	5%	50V
C330	1-101-361-00	CERAMIC	150PF	5%	50V
C401	1-123-875-11	ELECT	10MF	20%	50V
C402	1-124-799-11	ELECT	2.2MF	20%	160V
C403	1-130-483-00	MYLAR	0.01MF	5%	50V
C404	1-102-316-00	CERAMIC	15PF	5%	500V
C405	1-106-367-00	MYLAR	0.01MF	10%	200V
C406	1-130-483-00	MYLAR	0.01MF	5%	50V
C407	1-130-491-00	MYLAR	0.047MF	5%	50V
C408	1-130-491-00	MYLAR	0.047MF	5%	50V
C409	1-130-491-00	MYLAR	0.047MF	5%	50V
C410	1-130-483-00	MYLAR	0.01MF	5%	50V
C411	1-102-316-00	CERAMIC	15PF	5%	500V
C412	1-130-483-00	MYLAR	0.01MF	5%	50V
C413	1-106-367-00	MYLAR	0.01MF	10%	200V
C416	1-102-316-00	CERAMIC	15PF	5%	500V

REF.NO.	PART NO.	DESCRIPTION	REMARK
C417	1-106-367-00	MYLAR	0.01MF 10% 200V
C4401	1-123-875-11	ELECT	10MF 20% 50V
C4402	1-123-875-11	ELECT	10MF 20% 50V
C4403	1-126-233-11	ELECT	22MF 20% 25V
C4404	1-126-233-11	ELECT	22MF 20% 25V
C4405	1-123-875-11	ELECT	10MF 20% 50V
C4406	1-123-875-11	ELECT	10MF 20% 50V
C4407	1-124-927-11	ELECT	4.7MF 20% 50V
C4408	1-124-927-11	ELECT	4.7MF 20% 50V
C4409	1-123-875-11	ELECT	10MF 20% 50V
C4410	1-126-101-11	ELECT	100MF 20% 16V
C4411	1-102-114-00	CERAMIC	470PF 10% 50V
C4412	1-102-116-00	CERAMIC	680PF 10% 50V
C4413	1-102-114-00	CERAMIC	470PF 10% 50V
C4414	1-123-875-11	ELECT	10MF 20% 50V
C4415	1-101-006-00	CERAMIC	0.047MF 50V
C4416	1-123-875-11	ELECT	10MF 20% 50V
C4417	1-124-120-11	ELECT	220MF 20% 16V
C4418	1-124-477-11	ELECT	47MF 20% 16V
C4419	1-124-477-11	ELECT	47MF 20% 16V
C4420	1-101-006-00	CERAMIC	0.047MF 50V
C4421	1-124-902-00	ELECT	0.47MF 20% 50V
C4422	1-101-006-00	CERAMIC	0.047MF 50V
C4426	1-126-101-11	ELECT	100MF 20% 16V
C4427	1-124-902-00	ELECT	0.47MF 20% 50V
C4428	1-102-074-00	CERAMIC	0.001MF 10% 50V
C4429	1-123-875-11	ELECT	10MF 20% 50V
C4601	1-102-978-00	CERAMIC	220PF 5% 50V
C4602	1-102-978-00	CERAMIC	220PF 5% 50V
C4603	1-102-978-00	CERAMIC	220PF 5% 50V
C4604	1-123-875-11	ELECT	10MF 20% 50V
C5001	1-124-499-11	ELECT	1MF 20% 50V
C5002	1-102-973-00	CERAMIC	100PF 5% 50V
C5003	1-130-483-00	MYLAR	0.01MF 5% 50V
C5004	1-131-341-00	TANTALUM	0.1MF 20% 35V
C5005	1-124-927-11	ELECT	4.7MF 20% 50V
C5006	1-123-875-11	ELECT	10MF 20% 50V
C5007	1-124-791-11	ELECT	1MF 20% 50V
C5008	1-124-791-11	ELECT	1MF 20% 50V
C5009	1-126-233-11	ELECT	22MF 20% 25V
C5010	1-126-101-11	ELECT	100MF 20% 16V
C5011	1-130-471-00	MYLAR	0.001MF 5% 50V
C5012	1-126-233-11	ELECT	22MF 20% 25V
C5013	1-126-101-11	ELECT	100MF 20% 16V
C5014	1-130-471-00	MYLAR	0.001MF 5% 50V
C5015	1-124-120-11	ELECT	220MF 20% 25V
C5016	1-124-120-11	ELECT	220MF 20% 25V
C5017	1-102-963-00	CERAMIC	33PF 5% 50V
C5018	1-102-963-00	CERAMIC	33PF 5% 50V
C5019	1-102-114-00	CERAMIC	470PF 10% 50V
C5020	1-102-114-00	CERAMIC	470PF 10% 50V
C5021	1-102-963-00	CERAMIC	33PF 5% 50V
C5022	1-102-963-00	CERAMIC	33PF 5% 50V
C5023	1-102-114-00	CERAMIC	470PF 10% 50V
C5024	1-102-114-00	CERAMIC	470PF 10% 50V
C5025	1-102-963-00	CERAMIC	33PF 5% 50V
C5026	1-102-963-00	CERAMIC	33PF 5% 50V
C5027	1-102-114-00	CERAMIC	470PF 10% 50V
C5028	1-102-114-00	CERAMIC	470PF 10% 50V
C5029	1-124-477-11	ELECT	47MF 20% 16V
C5030	1-130-471-00	MYLAR	0.001MF 5% 50V
C5031	1-130-471-00	MYLAR	0.001MF 5% 50V
C5032	1-124-477-11	ELECT	47MF 20% 16V

REF.NO.	PART NO.	DESCRIPTION	REMARK	REF.NO.	PART NO.	DESCRIPTION	REMARK
C5033	1-102-973-00	CERAMIC 100PF 5% 50V		Q304	8-729-119-78	TRANSISTOR 2SC2785-HFE	
		<DIODE>		Q305	8-729-119-78	TRANSISTOR 2SC2785-HFE	
D301	8-719-110-88	DIODE RD39ES-B2		Q306	8-729-119-78	TRANSISTOR 2SC2785-HFE	
D302	8-719-110-88	DIODE RD39ES-B2		Q307	8-729-119-76	TRANSISTOR 2SA1175-HFE	
D303	8-719-911-19	DIODE 1SS119		Q308	8-729-119-78	TRANSISTOR 2SC2785-HFE	
D304	8-719-110-35	DIODE RD13ES-B1		Q309 A. 8-729-119-78 TRANSISTOR 2SC2785-HFE			
D305 A. 8-719-110-30 DIODE RD12ES-B1				Q310	8-729-119-76	TRANSISTOR 2SA1175-HFE	
D306	8-719-911-19	DIODE 1SS119		Q311	8-729-119-78	TRANSISTOR 2SC2785-HFE	
D307	8-719-911-19	DIODE 1SS119		Q312 A. 8-729-119-78 TRANSISTOR 2SC2785-HFE			
D308	8-719-911-19	DIODE 1SS119		Q313 A. 8-729-119-78 TRANSISTOR 2SC2785-HFE			
D401	8-719-911-19	DIODE 1SS119		Q401	8-729-119-76	TRANSISTOR 2SA1175-HFE	
D402	8-719-911-19	DIODE 1SS119		Q402	8-729-119-78	TRANSISTOR 2SC2785-HFE	
D403	8-719-911-19	DIODE 1SS119		Q403	8-729-238-32	TRANSISTOR 2SC2383-0	
D404	8-719-911-19	DIODE 1SS119		Q404	8-729-231-60	TRANSISTOR 2SD1406-YGR	
D405	8-719-971-20	DIODE ERC38-06		Q405	8-729-111-67	TRANSISTOR 2SB1094-L	
D406	8-719-911-19	DIODE 1SS119		Q406 A. 8-729-238-32 TRANSISTOR 2SC2383-0			
D407	8-719-911-19	DIODE 1SS119		Q407	8-729-231-60	TRANSISTOR 2SD1406-YGR	
D408	8-719-911-19	DIODE 1SS119		Q408	8-729-111-67	TRANSISTOR 2SB1094-L	
D4404	8-719-911-19	DIODE 1SS119		Q409	8-729-238-32	TRANSISTOR 2SC2383-0	
D4405	8-719-911-19	DIODE 1SS119		Q410	8-729-231-60	TRANSISTOR 2SD1406-YGR	
D4406	8-719-911-19	DIODE 1SS119		Q411	8-729-111-67	TRANSISTOR 2SB1094-L	
D4407	8-719-911-19	DIODE 1SS119		Q4401	8-729-119-78	TRANSISTOR 2SC2785-HFE	
D4408	8-719-911-19	DIODE 1SS119		Q4402	8-729-119-78	TRANSISTOR 2SC2785-HFE	
D4409	8-719-911-19	DIODE 1SS119		Q4403	8-729-801-46	TRANSISTOR 2SC3064-F	
D4410	8-719-911-19	DIODE 1SS119		Q4406	8-729-803-37	TRANSISTOR 2SA1237-F	
D4411	8-719-911-19	DIODE 1SS119		Q4408	8-729-119-76	TRANSISTOR 2SA1175-HFE	
D4412	8-719-911-19	DIODE 1SS119		Q4409	8-729-119-78	TRANSISTOR 2SC2785-HFE	
D4413	8-719-911-19	DIODE 1SS119		Q4410	8-729-119-78	TRANSISTOR 2SC2785-HFE	
D4414	8-719-911-19	DIODE 1SS119		Q4411	8-729-801-46	TRANSISTOR 2SC3064-F	
D4417	8-719-911-19	DIODE 1SS119		Q4413	8-729-803-37	TRANSISTOR 2SA1237-F	
D4418	8-719-911-19	DIODE 1SS119		Q4414	8-729-803-37	TRANSISTOR 2SA1237-F	
D4428	8-719-911-19	DIODE 1SS119		Q4416	8-729-119-76	TRANSISTOR 2SA1175-HFE	
D4429	8-719-911-19	DIODE 1SS119		Q4417	8-729-119-78	TRANSISTOR 2SC2785-HFE	
		<IC>		Q4418	8-729-801-46	TRANSISTOR 2SC3064-F	
IC401	8-759-945-58	IC RC4558P		Q4420	8-729-803-37	TRANSISTOR 2SA1237-F	
IC402	8-759-945-58	IC RC4558P		Q4421	8-729-803-37	TRANSISTOR 2SA1237-F	
IC4401	8-759-945-58	IC RC4558P		Q4423	8-729-119-76	TRANSISTOR 2SA1175-HFE	
IC4402	8-759-945-58	IC RC4558P		Q4424	8-729-119-78	TRANSISTOR 2SC2785-HFE	
IC5001	8-752-033-68	IC CXA1268P		Q4425	8-729-119-76	TRANSISTOR 2SA1175-HFE	
IC5002	8-759-982-21	IC RC78L05A		Q4426	8-729-119-78	TRANSISTOR 2SC2785-HFE	
IC5003	8-759-982-44	IC RC79L05A		Q4427	8-729-119-76	TRANSISTOR 2SA1175-HFE	
IC5004	8-759-602-19	IC M5220L		Q4428	8-729-119-78	TRANSISTOR 2SC2785-HFE	
IC5005	8-759-602-19	IC M5220L		Q4429	8-729-119-76	TRANSISTOR 2SA1175-HFE	
IC5006	8-759-602-19	IC M5220L		Q4430	8-729-119-78	TRANSISTOR 2SC2785-HFE	
		<COIL>		Q4431	8-729-119-76	TRANSISTOR 2SA1175-HFE	
L301	1-410-470-11	INDUCTOR 10UH		Q4432	8-729-803-82	TRANSISTOR 2SC3468-E	
L302	1-410-470-11	INDUCTOR 10UH		Q4433	8-729-119-76	TRANSISTOR 2SA1175-HFE	
L303	1-408-421-00	INDUCTOR 100UH		Q4434	8-729-119-76	TRANSISTOR 2SA1175-HFE	
L304	1-410-468-11	INDUCTOR 6.8UH		Q4435	8-729-119-78	TRANSISTOR 2SC2785-HFE	
L305	1-410-468-11	INDUCTOR 6.8UH		Q4436	8-729-119-78	TRANSISTOR 2SC2785-HFE	
L5001	1-459-155-00	COIL (WITH CORE) 45UH		Q4437	8-729-119-78	TRANSISTOR 2SC2785-HFE	
L5002	1-459-155-00	COIL (WITH CORE) 45UH		Q4438	8-729-119-78	TRANSISTOR 2SC2785-HFE	
		<TRANSISTOR>		Q4439	8-729-119-78	TRANSISTOR 2SC2785-HFE	
Q301 A. 8-729-122-03 TRANSISTOR 2SA1220A-P				Q4440	8-729-119-78	TRANSISTOR 2SC2785-HFE	
Q302 A. 8-729-106-92 TRANSISTOR 2SC2690A-Q				Q4441	8-729-119-76	TRANSISTOR 2SA1175-HFE	
Q303	8-729-119-78	TRANSISTOR 2SC2785-HFE		Q4442	8-729-900-89	TRANSISTOR DTC144ES	
				Q4450	8-729-803-37	TRANSISTOR 2SA1237-F	
				Q4501	8-729-119-76	TRANSISTOR 2SA1175-HFE	
				Q4502	8-729-119-78	TRANSISTOR 2SC2785-HFE	
				Q4503	8-729-119-78	TRANSISTOR 2SC2785-HFE	
				Q4504	8-729-119-78	TRANSISTOR 2SC2785-HFE	
				Q4505	8-729-119-78	TRANSISTOR 2SC2785-HFE	
				Q5001	8-729-231-60	TRANSISTOR 2SD1406-YGR	

REF.NO.	PART NO.	DESCRIPTION	REMARK	REF.NO.	PART NO.	DESCRIPTION	REMARK
Q5002	8-729-111-67	TRANSISTOR 2SB1094-L		R416	1-215-875-11	METAL OXIDE	10K 5% 1W F
Q5003	8-729-231-60	TRANSISTOR 2SD1406-YGR		R417	1-249-405-11	CARBON	100 5% 1/4W F
Q5004	8-729-111-67	TRANSISTOR 2SB1094-L		R418	1-249-429-11	CARBON	10K 5% 1/4W
Q5005	8-729-231-60	TRANSISTOR 2SD1406-YGR		R419	1-215-441-00	METAL	6.8K 1% 1/6W
Q5006	8-729-111-67	TRANSISTOR 2SB1094-L		R420	1-215-453-00	METAL	22K 1% 1/6W
Q5007	8-729-231-60	TRANSISTOR 2SD1406-YGR		R421	1-215-461-00	METAL	47K 1% 1/6W
Q5008	8-729-111-67	TRANSISTOR 2SB1094-L		R422	1-215-425-00	METAL	1.5K 1% 1/6W
Q5009	8-729-231-60	TRANSISTOR 2SD1406-YGR		R423	1-215-441-00	METAL	6.8K 1% 1/6W
Q5010	8-729-111-67	TRANSISTOR 2SB1094-L		R424	1-215-425-00	METAL	1.5K 1% 1/6W
Q5011	8-729-231-60	TRANSISTOR 2SD1406-YGR		R425	1-215-425-00	METAL	1.5K 1% 1/6W
Q5012	8-729-111-67	TRANSISTOR 2SB1094-L		R426 Δ	1-249-405-91	CARBON	100 5% 1/4W F
<RESISTOR>				R427	1-216-512-11	METAL OXIDE	18K 5% 5W F
R301	1-249-417-11	CARBON	1K 5% 1/4W F	R428	1-215-445-00	METAL	10K 1% 1/6W
R302	1-249-393-11	CARBON	10 5% 1/4W F	R429	1-215-418-00	METAL	750 1% 1/6W
R303	1-249-405-11	CARBON	100 5% 1/4W	R430 Δ	1-249-393-91	CARBON	10 5% 1/4W F
R304	1-249-439-11	CARBON	68K 5% 1/4W	R431 Δ	1-249-405-91	CARBON	100 5% 1/4W F
R305	1-249-429-11	CARBON	10K 5% 1/4W	R432	1-249-429-11	CARBON	10K 5% 1/4W
R306	1-249-439-11	CARBON	68K 5% 1/4W	R433	1-215-441-00	METAL	6.8K 1% 1/6W
R307	1-249-405-11	CARBON	100 5% 1/4W	R434	1-249-429-11	CARBON	10K 5% 1/4W
R308	1-249-417-11	CARBON	1K 5% 1/4W F	R435	1-215-441-00	METAL	6.8K 1% 1/6W
R309	1-249-393-11	CARBON	10 5% 1/4W F	R436	1-215-875-11	METAL OXIDE	10K 5% 1W F
R310	1-215-915-11	METAL OXIDE	470 5% 3W F	R438	1-216-512-11	METAL OXIDE	18K 5% 5W F
R311	1-249-417-11	CARBON	1K 5% 1/4W	R439	1-215-445-00	METAL	10K 1% 1/6W
R312	1-249-417-11	CARBON	1K 5% 1/4W	R440	1-215-418-00	METAL	750 1% 1/6W
R313	1-249-424-11	CARBON	3.9K 5% 1/4W	R441	1-249-393-11	CARBON	10 5% 1/4W F
R314	1-249-434-11	CARBON	27K 5% 1/4W	R442	1-215-875-11	METAL OXIDE	10K 5% 1W F
R315	1-249-409-11	CARBON	220 5% 1/4W	R443	1-249-480-11	CARBON	3.3 5% 1/2W
R316	1-249-422-11	CARBON	2.7K 5% 1/4W	R444	1-249-480-11	CARBON	3.3 5% 1/2W
R317	1-249-414-11	CARBON	560 5% 1/4W	R449	1-249-480-11	CARBON	3.3 5% 1/2W
R318	1-249-416-11	CARBON	820 5% 1/4W	R450	1-249-480-11	CARBON	3.3 5% 1/2W
R319	1-249-409-11	CARBON	220 5% 1/4W	R451	1-205-941-11	WIREWOUND	8.2K 10% 7W
R320	1-249-409-11	CARBON	220 5% 1/4W	*4-341-751-01	EYELET; R451		
R321	1-249-409-11	CARBON	220 5% 1/4W	R455	1-249-480-11	CARBON	3.3 5% 1/2W
R322	1-249-441-11	CARBON	100K 5% 1/4W	R456	1-249-480-11	CARBON	3.3 5% 1/2W
R323	1-249-430-11	CARBON	12K 5% 1/4W	R4401	1-249-437-11	CARBON	47K 5% 1/4W
R324	1-249-429-11	CARBON	10K 5% 1/4W	R4402	1-249-423-11	CARBON	3.3K 5% 1/4W
R325	1-249-416-11	CARBON	820 5% 1/4W	R4403	1-249-429-11	CARBON	10K 5% 1/4W
R326 Δ	1-249-393-91	CARBON	10 5% 1/4W F	R4404	1-249-429-11	CARBON	10K 5% 1/4W
R327	1-249-409-11	CARBON	220 5% 1/4W	R4405	1-249-425-11	CARBON	4.7K 5% 1/4W
R328	1-249-393-11	CARBON	10 5% 1/4W F	R4406	1-249-425-11	CARBON	4.7K 5% 1/4W
R329	1-249-429-11	CARBON	10K 5% 1/4W	R4407	1-249-423-11	CARBON	3.3K 5% 1/4W
R330	1-216-429-00	METAL OXIDE	270 5% 1W F	R4408	1-249-425-11	CARBON	4.7K 5% 1/4W
R331	1-216-440-00	METAL OXIDE	18K 5% 1W F	R4409	1-249-409-11	CARBON	220 5% 1/4W
R332 Δ	1-215-915-51	METAL OXIDE	470 5% 3W F	R4410	1-249-409-11	CARBON	220 5% 1/4W
R333	1-215-877-11	METAL OXIDE	22K 5% 1W F	R4411	1-249-429-11	CARBON	10K 5% 1/4W
R334	1-249-392-11	CARBON	8.2 5% 1/4W F	R4412	1-249-409-11	CARBON	220 5% 1/4W
R336	1-249-429-11	CARBON	10K 5% 1/4W	R4413	1-249-425-11	CARBON	4.7K 5% 1/4W
R401	1-249-433-11	CARBON	22K 5% 1/4W	R4414	1-249-414-11	CARBON	560 5% 1/4W
R402	1-249-441-11	CARBON	100K 5% 1/4W	R4415	1-249-411-11	CARBON	330 5% 1/4W
R404	1-249-433-11	CARBON	22K 5% 1/4W	R4416	1-249-423-11	CARBON	3.3K 5% 1/4W
R405	1-249-429-11	CARBON	10K 5% 1/4W	R4417	1-249-429-11	CARBON	10K 5% 1/4W
R406	1-249-433-11	CARBON	22K 5% 1/4W	R4418	1-249-423-11	CARBON	3.3K 5% 1/4W
R407	1-249-429-11	CARBON	10K 5% 1/4W	R4419	1-249-417-11	CARBON	1K 5% 1/4W
R408	1-249-423-11	CARBON	3.3K 5% 1/4W	R4420	1-249-417-11	CARBON	1K 5% 1/4W
R409	1-249-423-11	CARBON	3.3K 5% 1/4W	R4421	1-249-429-11	CARBON	10K 5% 1/4W
R410	1-249-405-11	CARBON	100 5% 1/4W F	R4422	1-249-429-11	CARBON	10K 5% 1/4W
R411	1-205-941-11	WIREWOUND	8.2K 10% 7W	R4423	1-249-417-11	CARBON	1K 5% 1/4W
R412	*4-341-751-01	EYELET; R411		R4424	1-249-417-11	CARBON	1K 5% 1/4W
R413	1-216-512-11	METAL OXIDE	18K 5% 5W F	R4425	1-249-417-11	CARBON	1K 5% 1/4W
R414	1-215-445-00	METAL	10K 1% 1/6W	R4426	1-249-417-11	CARBON	1K 5% 1/4W
R415	1-215-418-00	METAL	750 1% 1/6W	R4427	1-249-417-11	CARBON	1K 5% 1/4W
	1-249-393-11	CARBON	10 5% 1/4W F	R4428	1-249-409-11	CARBON	220 5% 1/4W
				R4429	1-249-409-11	CARBON	220 5% 1/4W

REF. NO.	PART NO.	DESCRIPTION	REMARK	REF. NO.	PART NO.	DESCRIPTION	REMARK
R4430	1-249-409-11	CARBON	220 5% 1/4W	R4560	1-249-401-11	CARBON	47 5% 1/4W
R4431	1-249-414-11	CARBON	560 5% 1/4W	R4561	1-215-413-00	METAL	470 1% 1/6W
R4432	1-249-425-11	CARBON	4.7K 5% 1/4W	R4562	1-249-394-11	CARBON	12 5% 1/4W
R4433	1-249-411-11	CARBON	330 5% 1/4W	R4564	1-249-429-11	CARBON	10K 5% 1/4W
R4434	1-249-409-11	CARBON	220 5% 1/4W	R4565	1-215-449-00	METAL	15K 1% 1/6W
R4435	1-249-409-11	CARBON	220 5% 1/4W	R4566	1-215-443-00	METAL	8.2K 1% 1/6W
R4436	1-249-409-11	CARBON	220 5% 1/4W	R4567	1-215-429-00	METAL	2.2K 1% 1/6W
R4437	1-249-414-11	CARBON	560 5% 1/4W	R4568	1-215-469-00	METAL	100K 1% 1/6W
R4438	1-249-425-11	CARBON	4.7K 5% 1/4W	R4569	1-249-409-11	CARBON	220 5% 1/4W
R4439	1-249-411-11	CARBON	330 5% 1/4W	R4570	1-249-393-11	CARBON	10 5% 1/4W
R4440	1-249-405-11	CARBON	100 5% 1/4W	R4572	1-249-429-11	CARBON	10K 5% 1/4W
R4441	1-215-425-00	METAL	1.5K 1% 1/6W	R4574	1-247-895-00	CARBON	470K 5% 1/4W
R4442	1-249-425-11	CARBON	4.7K 5% 1/4W	R4575	1-215-449-00	METAL	15K 1% 1/6W
R4443	1-249-405-11	CARBON	100 5% 1/4W	R4577	1-215-435-00	METAL	3.9K 1% 1/6W
R4444	1-249-401-11	CARBON	47 5% 1/4W	R4578	1-249-431-11	CARBON	15K 5% 1/4W
R4445	1-215-413-00	METAL	470 1% 1/6W	R4579	1-249-429-11	CARBON	10K 5% 1/4W
R4446	1-249-385-11	CARBON	2.2 5% 1/4W	R4598	1-249-407-11	CARBON	150 5% 1/4W
R4447	1-249-409-11	CARBON	220 5% 1/4W	R4599	1-249-412-11	CARBON	390 5% 1/4W
R4448	1-249-405-11	CARBON	100 5% 1/4W	R4610	1-249-417-11	CARBON	1K 5% 1/4W
R4449	1-215-425-00	METAL	1.5K 1% 1/6W	R4611	1-249-424-11	CARBON	3.9K 5% 1/4W
R4450	1-249-425-11	CARBON	4.7K 5% 1/4W	R4612	1-249-421-11	CARBON	2.2K 5% 1/4W
R4451	1-249-405-11	CARBON	100 5% 1/4W	R4613	1-249-421-11	CARBON	2.2K 5% 1/4W
R4452	1-215-413-00	METAL	470 1% 1/6W	R4614	1-249-417-11	CARBON	1K 5% 1/4W
R4453	1-249-385-11	CARBON	2.2 5% 1/4W	R4618	1-249-417-11	CARBON	1K 5% 1/4W
R4454	1-249-401-11	CARBON	47 5% 1/4W	R4619	1-249-417-11	CARBON	1K 5% 1/4W
R4455	1-215-405-00	METAL	220 1% 1/6W	R4621	1-249-416-11	CARBON	820 5% 1/4W
R4456	1-249-426-11	CARBON	5.6K 5% 1/4W	R4622	1-249-419-11	CARBON	1.5K 5% 1/4W
R4457	1-215-461-00	METAL	47K 1% 1/6W	R4623	1-249-409-11	CARBON	220 5% 1/4W
R4471	1-249-437-11	CARBON	47K 5% 1/4W	R5001	1-215-455-00	METAL	27K 1% 1/6W
R4472	1-249-437-11	CARBON	47K 5% 1/4W	R5002	1-215-457-00	METAL	33K 1% 1/6W
R4473	1-215-469-00	METAL	100K 1% 1/6W	R5003	1-215-455-00	METAL	27K 1% 1/6W
R4474	1-215-461-00	METAL	47K 1% 1/6W	R5004	1-215-469-00	METAL	100K 1% 1/6W
R4475	1-215-469-00	METAL	100K 1% 1/6W	R5005	1-215-469-00	METAL	100K 1% 1/6W
R4476	1-215-461-00	METAL	47K 1% 1/6W	R5006	1-215-469-00	METAL	100K 1% 1/6W
R4477	1-215-469-00	METAL	100K 1% 1/6W	R5007	1-249-420-11	CARBON	1.8K 5% 1/4W
R4478	1-215-461-00	METAL	47K 1% 1/6W	R5008	1-215-441-00	METAL	6.8K 1% 1/6W
R4479	1-215-469-00	METAL	100K 1% 1/6W	R5009	1-215-427-00	METAL	1.8K 1% 1/6W
R4480	1-249-419-11	CARBON	1.5K 5% 1/4W	R5010	1-215-453-00	METAL	22K 1% 1/6W
R4481	1-249-405-11	CARBON	100 5% 1/4W	R5011	1-215-439-00	METAL	5.6K 1% 1/6W
R4482	1-249-419-11	CARBON	1.5K 5% 1/4W	R5012	1-215-453-00	METAL	22K 1% 1/6W
R4483	1-215-449-00	METAL	15K 1% 1/6W	R5013	1-249-421-11	CARBON	2.2K 5% 1/4W
R4484	1-215-453-00	METAL	22K 1% 1/6W	R5014	1-215-451-00	METAL	18K 1% 1/6W
R4485	1-215-445-00	METAL	10K 1% 1/6W	R5015	1-249-421-11	CARBON	2.2K 5% 1/4W
R4486	1-249-432-11	CARBON	18K 5% 1/4W	R5016	1-249-441-11	CARBON	100K 5% 1/4W
R4487	1-215-431-00	METAL	2.7K 1% 1/6W	R5017	1-247-897-11	CARBON	560K 5% 1/4W
R4488	1-215-443-00	METAL	8.2K 1% 1/6W	R5018	1-249-441-11	CARBON	100K 5% 1/4W
R4489	1-215-443-00	METAL	8.2K 1% 1/6W	R5019	1-249-423-11	CARBON	3.3K 5% 1/4W
R4490	1-215-443-00	METAL	8.2K 1% 1/6W	R5020	1-249-423-11	CARBON	3.3K 5% 1/4W
R4491	1-249-429-11	CARBON	10K 5% 1/4W	R5021	1-249-423-11	CARBON	3.3K 5% 1/4W
R4492	1-247-887-00	CARBON	220K 5% 1/4W	R5022	1-249-423-11	CARBON	3.3K 5% 1/4W
R4493	1-247-887-00	CARBON	220K 5% 1/4W	R5023	1-249-423-11	CARBON	3.3K 5% 1/4W
R4494	1-247-887-00	CARBON	220K 5% 1/4W	R5024	1-249-423-11	CARBON	3.3K 5% 1/4W
R4495	1-215-477-00	METAL	220K 1% 1/6W	R5025	1-215-439-00	METAL	5.6K 1% 1/6W
R4496	1-215-469-00	METAL	100K 1% 1/6W	R5026	1-215-459-00	METAL	39K 1% 1/6W
R4497	1-249-429-11	CARBON	10K 5% 1/4W	R5027	1-215-439-00	METAL	5.6K 1% 1/6W
R4499	1-249-405-11	CARBON	100 5% 1/4W	R5028	1-215-421-00	METAL	1K 1% 1/6W
R4500	1-249-441-11	CARBON	100K 5% 1/4W	R5029	1-215-429-00	METAL	2.2K 1% 1/6W
R4501	1-249-417-11	CARBON	1K 5% 1/4W	R5030	1-249-427-11	CARBON	6.8K 5% 1/4W
R4502	1-249-414-11	CARBON	560 5% 1/4W	R5031	1-249-432-11	CARBON	18K 5% 1/4W
R4510	1-249-423-11	CARBON	3.3K 5% 1/4W	R5032	1-249-427-11	CARBON	6.8K 5% 1/4W
R4556	1-249-405-11	CARBON	100 5% 1/4W	R5033	1-249-429-11	CARBON	10K 5% 1/4W
R4557	1-215-425-00	METAL	1.5K 1% 1/6W	R5034	1-249-429-11	CARBON	10K 5% 1/4W
R4558	1-249-425-11	CARBON	4.7K 5% 1/4W	R5035	1-249-429-11	CARBON	10K 5% 1/4W
R4559	1-249-405-11	CARBON	100 5% 1/4W				

REF.NO.	PART NO.	DESCRIPTION	REMARK	REF.NO.	PART NO.	DESCRIPTION	REMARK
RV5021	1-238-017-11	RES. ADJ. CARBON 22K		D1005	8-719-911-19	DIODE 1SS119	
RV5022	1-238-017-11	RES. ADJ. CARBON 22K		D1006	8-719-915-45	DIODE SLP162B	
RV5023	1-238-017-11	RES. ADJ. CARBON 22K		D1007	8-719-911-19	DIODE 1SS119	
RV5024	1-238-017-11	RES. ADJ. CARBON 22K		D1008	8-719-915-45	DIODE SLP162B	
RV5025	1-238-017-11	RES. ADJ. CARBON 22K					
RV5026	1-238-018-11	RES. ADJ. CARBON 33K					
RV5027	1-238-017-11	RES. ADJ. CARBON 22K					
RV5028	1-238-014-11	RES. ADJ. CARBON 3.3K					
RV5029	1-238-015-11	RES. ADJ. CARBON 4.7K					
RV5030	1-238-017-11	RES. ADJ. CARBON 22K					
RV5031	1-238-017-11	RES. ADJ. CARBON 22K					
RV5032	1-238-017-11	RES. ADJ. CARBON 22K					
RV5033	1-238-017-11	RES. ADJ. CARBON 22K					
RV5034	1-238-017-11	RES. ADJ. CARBON 22K					
RV5035	1-238-017-11	RES. ADJ. CARBON 22K					
RV5036	1-238-017-11	RES. ADJ. CARBON 22K					
RV5037	1-238-019-11	RES. ADJ. CARBON 47K					
RV5038	1-238-017-11	RES. ADJ. CARBON 22K					
RV5039	1-238-016-11	RES. ADJ. CARBON 10K					
RV5040	1-238-014-11	RES. ADJ. CARBON 3.3K					
RV5041	1-238-016-11	RES. ADJ. CARBON 10K					
RV5042	1-238-017-11	RES. ADJ. CARBON 22K					
RV5043	1-238-017-11	RES. ADJ. CARBON 22K					
RV5044	1-238-017-11	RES. ADJ. CARBON 22K					
RV5045	1-238-017-11	RES. ADJ. CARBON 22K					
RV5046	1-238-017-11	RES. ADJ. CARBON 22K					
RV5047	1-238-017-11	RES. ADJ. CARBON 22K					
RV5048	1-238-017-11	RES. ADJ. CARBON 22K					
RV5049	1-238-017-11	RES. ADJ. CARBON 22K					
RV5050	1-238-017-11	RES. ADJ. CARBON 22K					
RV5051	1-238-017-11	RES. ADJ. CARBON 22K					
RV5052	1-238-017-11	RES. ADJ. CARBON 22K					
RV5053	1-238-017-11	RES. ADJ. CARBON 22K					
RV5058	1-238-017-11	RES. ADJ. CARBON 22K					
<SWITCH>							
S5001	1-570-865-11	SWITCH, SLIDE					

*1-625-921-11	H BOARD						

*1-564-521-11	PLUG, CONNECTOR 6P						
*1-564-523-11	PLUG, CONNECTOR 8P						
*1-564-527-11	PLUG, CONNECTOR 12P						
*4-374-421-01	HOLDER (A), LED						
<CAPACITOR>							
C1001	1-102-110-00	CERAMIC 220PF	10% 50V				
C1002	1-102-110-00	CERAMIC 220PF	10% 50V				
C1003	1-130-483-00	MYLAR 0.01MF	5% 50V				
C1004	1-130-483-00	MYLAR 0.01MF	5% 50V				
C1005	1-130-483-00	MYLAR 0.01MF	5% 50V				
C1006	1-131-381-00	TANTALUM 47MF	10% 10V				
C1007	1-131-343-00	TANTALUM 0.22MF	10% 35V				
C1008	1-124-589-11	ELECT 47MF	20% 10V				
C1009	1-124-589-11	ELECT 47MF	20% 10V				
<DIODE>							
D1001	8-719-911-19	DIODE 1SS119					
D1003	8-719-109-68	DIODE RD3.6ES-B1					
D1004	8-719-911-19	DIODE 1SS119					
<IC>							
IC1001*	8-759-630-17	IC M50461-064SP					
IC1002	8-741-148-33	IC SBX1483-59					
<JACK>							
J1001	1-563-303-11	JACK BLOCK, PIN 3P					
<COIL>							
L1001	1-408-421-00	INDUCTOR 100UH					
<TRANSISTOR>							
Q1002	8-729-119-78	TRANSISTOR 2SC2785-HFE					
Q1004	8-729-119-76	TRANSISTOR 2SA1175-HFE					
<RESISTOR>							
R1001	1-249-425-11	CARBON 4.7K 5%	1/4W				
R1002	1-249-418-11	CARBON 1.2K 5%	1/4W				
R1006	1-249-417-11	CARBON 1K 5%	1/4W				
R1007	1-249-441-11	CARBON 100K 5%	1/4W				
R1008	1-249-421-11	CARBON 2.2K 5%	1/4W				
R1009	1-249-437-11	CARBON 47K 5%	1/4W				
R1010	1-249-444-11	CARBON 100K 5%	1/4W				
R1020	1-249-417-11	CARBON 1K 5%	1/4W				
R1021	1-249-417-11	CARBON 1K 5%	1/4W				
R1022	1-249-417-11	CARBON 1K 5%	1/4W				
R1023	1-249-417-11	CARBON 1K 5%	1/4W				
R1024	1-247-713-11	CARBON 1K 5%	1/4W				
R1025	1-249-417-11	CARBON 1K 5%	1/4W				
R1026	1-247-713-11	CARBON 1K 5%	1/4W				
R1027	1-249-409-11	CARBON 220 5%	1/4W				
<VARIABLE RESISTOR>							
RV1001	1-237-994-11	RES. VAR. CARBON 20K					
RV1002	1-237-994-11	RES. VAR. CARBON 20K					
RV1003	1-237-994-11	RES. VAR. CARBON 20K					
RV1004	1-237-994-11	RES. VAR. CARBON 20K					
<SWITCH>							
S1001	1-554-303-21	SWITCH, KEY BOARD					
S1002	1-554-303-21	SWITCH, KEY BOARD					
S1003	1-554-303-21	SWITCH, KEY BOARD					
S1004	1-554-303-21	SWITCH, KEY BOARD					
S1009	1-554-303-21	SWITCH, KEY BOARD					
S1017A	1-554-336-11	SWITCH, KEY BOARD					
S1018	1-570-865-11	SWITCH, SLIDE					
S1019	1-570-865-11	SWITCH, SLIDE					
S1020	1-570-865-11	SWITCH, SLIDE					
S1021	1-570-865-11	SWITCH, SLIDE					
<CRYSTAL>							
X1001	1-527-476-00	OSCILLATOR, CERAMIC					

REF. NO.	PART NO.	DESCRIPTION	REMARK	REF. NO.	PART NO.	DESCRIPTION	REMARK
*****				C8607	1-124-589-11	ELECT 47MF	20% 16V
*****				C8608	1-124-791-11	ELECT 1MF	20% 50V
*****				C8700	1-102-949-00	CERAMIC 12PF	5% 50V
*****				C8703	1-126-101-11	ELECT 100MF	20% 16V
*****				<COMPOSITION CIRCUIT BLOCK>			
*****				CP8501	1-231-619-00	COMPOSITION CIRCUIT BLOCK	
*****				CP8502	1-231-619-00	COMPOSITION CIRCUIT BLOCK	
*****				<DIODE>			
*****				D8100	8-719-911-19	DIODE 1SS119	
*****				D8101	8-719-911-19	DIODE 1SS119	
*****				D8102	8-719-911-19	DIODE 1SS119	
*****				D8103	8-719-911-19	DIODE 1SS119	
*****				D8104	8-719-911-19	DIODE 1SS119	
*****				D8106	8-719-911-19	DIODE 1SS119	
*****				D8200	8-719-110-36	DIODE RD13ES-B2	
*****				D8201	8-719-110-36	DIODE RD13ES-B2	
*****				D8202	8-719-109-88	DIODE RD5.6ES-B1	
*****				D8203	8-719-110-36	DIODE RD13ES-B2	
*****				D8204	8-719-110-17	DIODE RD10ES-B2	
*****				D8205	8-719-110-17	DIODE RD10ES-B2	
*****				D8206	8-719-110-36	DIODE RD13ES-B2	
*****				D8207	8-719-110-36	DIODE RD13ES-B2	
*****				D8208	8-719-110-17	DIODE RD10ES-B2	
*****				D8209	8-719-110-17	DIODE RD10ES-B2	
*****				D8210	8-719-110-17	DIODE RD10ES-B2	
*****				D8211	8-719-110-17	DIODE RD10ES-B2	
*****				D8212	8-719-110-36	DIODE RD13ES-B2	
*****				D8213	8-719-110-36	DIODE RD13ES-B2	
*****				D8214	8-719-110-36	DIODE RD13ES-B2	
*****				D8400	8-719-911-19	DIODE 1SS119	
*****				D8401	8-719-911-19	DIODE 1SS119	
*****				D8500	8-719-911-19	DIODE 1SS119	
*****				D8600	8-719-110-36	DIODE RD13ES-B2	
*****				D8601	8-719-911-19	DIODE 1SS119	
*****				D8602	8-719-110-36	DIODE RD13ES-B2	
*****				D8603	8-719-911-19	DIODE 1SS119	
*****				D8604	8-719-911-19	DIODE 1SS119	
*****				D8605	8-719-911-19	DIODE 1SS119	
*****				D8606	8-719-911-19	DIODE 1SS119	
*****				<IC>			
*****				IC8100	8-759-000-49	IC MC14066BCP	
*****				IC8400	8-752-037-04	IC CX-7948A	
*****				IC8500	8-759-820-63	IC LA7953	
*****				IC8501	8-759-000-48	IC MC14052BCP	
*****				IC8503	8-759-008-71	IC LM324N	
*****				IC8600	8-759-000-49	IC MC14066BCP	
*****				IC8601	1-464-880-11	FILTER BLOCK, COM (CFB-2)	
*****				<JACK>			
*****				J8200	1-565-166-11	PIN JACK BLOCK, (S) TERMINAL 3P	
*****				J8201	1-563-305-11	JACK BLOCK, PIN 6P	
*****				J8202	1-563-302-11	JACK BLOCK, PIN 2P	
*****				<TRANSISTOR>			
*****				Q103	8-729-119-78	TRANSISTOR 2SC2785-HFE	
*****				<CAPACITOR>			
C8001	1-124-360-00	ELECT	1000MF	20%	16V		
C8100	1-124-360-00	ELECT	1000MF	20%	16V		
C8101	1-124-477-11	ELECT	47MF	20%	16V		
C8103	1-124-477-11	ELECT	47MF	20%	16V		
C8104	1-126-101-11	ELECT	100MF	20%	16V		
C8105	1-124-477-11	ELECT	47MF	20%	16V		
C8200	1-124-589-11	ELECT	47MF	20%	16V		
C8201	1-126-301-11	ELECT	1MF	20%	50V		
C8202	1-126-301-11	ELECT	1MF	20%	50V		
C8203	1-124-477-11	ELECT	47MF	20%	16V		
C8204	1-124-791-11	ELECT	1MF	20%	50V		
C8205	1-124-791-11	ELECT	1MF	20%	50V		
C8206	1-124-589-11	ELECT	47MF	20%	16V		
C8207	1-126-301-11	ELECT	1MF	20%	50V		
C8208	1-126-301-11	ELECT	1MF	20%	50V		
C8209	1-124-473-11	ELECT	1000MF	20%	10V		
C8210	1-124-589-11	ELECT	47MF	20%	16V		
C8211	1-124-589-11	ELECT	47MF	20%	16V		
C8212	1-126-301-11	ELECT	1MF	20%	50V		
C8213	1-126-301-11	ELECT	1MF	20%	50V		
C8300	1-124-360-00	ELECT	1000MF	20%	16V		
C8400	1-126-101-11	ELECT	100MF	20%	16V		
C8401	1-124-477-11	ELECT	47MF	20%	16V		
C8403	1-124-477-11	ELECT	47MF	20%	16V		
C8404	1-102-963-00	CERAMIC	33PF	5%	50V		
C8500	1-124-791-11	ELECT	1MF	20%	50V		
C8501	1-124-791-11	ELECT	1MF	20%	50V		
C8502	1-108-812-11	MYLAR	0.047MF	5%	50V		
C8503	1-123-875-11	ELECT	10MF	20%	50V		
C8504	1-130-483-00	MYLAR	0.01MF	5%	50V		
C8505	1-136-169-00	FILM	0.22MF	5%	50V		
C8506	1-136-169-00	FILM	0.22MF	5%	50V		
C8507	1-130-483-00	MYLAR	0.01MF	5%	50V		
C8508	1-123-875-11	ELECT	10MF	20%	50V		
C8509	1-123-875-11	ELECT	10MF	20%	50V		
C8510	1-124-119-00	ELECT	330MF	20%	16V		
C8511	1-126-101-11	ELECT	100MF	20%	16V		
C8512	1-124-902-00	ELECT	0.47MF	20%	50V		
C8513	1-124-465-00	ELECT	0.47MF	20%	50V		
C8514	1-123-875-11	ELECT	10MF	20%	50V		
C8515	1-123-875-11	ELECT	10MF	20%	50V		
C8516	1-124-477-11	ELECT	47MF	20%	16V		
C8521	1-124-478-11	ELECT	100MF	20%	25V		
C8522	1-126-103-11	ELECT	470MF	20%	16V		
C8523	1-124-477-11	ELECT	47MF	20%	16V		
C8600	1-130-483-00	MYLAR	0.01MF	5%	50V		
C8601	1-124-589-11	ELECT	47MF	20%	16V		
C8603	1-124-589-11	ELECT	47MF	20%	16V		
C8604	1-124-589-11	ELECT	47MF	20%	16V		
C8606	1-124-589-11	ELECT	47MF	20%	16V		

REF. NO.	PART NO.	DESCRIPTION	REMARK	REF. NO.	PART NO.	DESCRIPTION	REMARK
Q104	8-729-119-76	TRANSISTOR 2SA1175-HFE		R8116	1-249-423-11	CARBON 3.3K 5%	1/4W
Q105	8-729-119-76	TRANSISTOR 2SA1175-HFE		R8117	1-249-417-11	CARBON 1K 5%	1/4W
Q106	8-729-119-76	TRANSISTOR 2SA1175-HFE					
Q8001	8-729-119-76	TRANSISTOR 2SA1175-HFE		R8118	1-249-417-11	CARBON 1K 5%	1/4W
Q8002	8-729-900-89	TRANSISTOR DTC144ES		R8119	1-249-417-11	CARBON 1K 5%	1/4W
				R8120	1-249-423-11	CARBON 3.3K 5%	1/4W
Q8100	8-729-900-89	TRANSISTOR DTC144ES		R8121	1-249-415-11	CARBON 680 5%	1/4W
Q8101	8-729-900-89	TRANSISTOR DTC144ES		R8122	1-249-415-11	CARBON 680 5%	1/4W
Q8102	8-729-119-76	TRANSISTOR 2SA1175-HFE					
Q8103	8-729-119-78	TRANSISTOR 2SC2785-HFE		R8123	1-249-420-11	CARBON 1.8K 5%	1/4W
Q8104	8-729-281-52	TRANSISTOR 2SC1815-Y		R8124	1-249-420-11	CARBON 1.8K 5%	1/4W
				R8125	1-249-420-11	CARBON 1.8K 5%	1/4W
Q8105	8-729-119-76	TRANSISTOR 2SA1175-HFE		R8126	1-249-420-11	CARBON 1.8K 5%	1/4W
Q8106	8-729-119-78	TRANSISTOR 2SC2785-HFE		R8127	1-249-420-11	CARBON 1.8K 5%	1/4W
Q8107	8-729-119-76	TRANSISTOR 2SA1175-HFE					
Q8108	8-729-900-89	TRANSISTOR DTC144ES		R8128	1-249-420-11	CARBON 1.8K 5%	1/4W
Q8109	8-729-119-78	TRANSISTOR 2SC2785-HFE		R8129	1-247-895-00	CARBON 470K 5%	1/4W
				R8130	1-249-405-11	CARBON 100 5%	1/4W
Q8400	8-729-119-76	TRANSISTOR 2SA1175-HFE		R8131	1-249-405-11	CARBON 100 5%	1/4W
Q8401	8-729-900-89	TRANSISTOR DTC144ES		R8132	1-249-397-11	CARBON 22 5%	1/4W
Q8402	8-729-119-78	TRANSISTOR 2SC2785-HFE					
Q8403	8-729-119-78	TRANSISTOR 2SC2785-HFE		R8133	1-249-405-11	CARBON 100 5%	1/4W
Q8404	8-729-900-89	TRANSISTOR DTC144ES		R8134	1-249-409-11	CARBON 220 5%	1/4W
				R8200	1-249-404-00	CARBON 82 5%	1/4W
Q8500	8-729-900-89	TRANSISTOR DTC144ES		R8201	1-249-417-11	CARBON 1K 5%	1/4W
Q8501 8-729-478-82 TRANSISTOR 2SC2785-HFE				R8202	1-247-895-00	CARBON 470K 5%	1/4W
Q8600	8-729-119-78	TRANSISTOR 2SC2785-HFE					
Q8601	8-729-119-78	TRANSISTOR 2SC2785-HFE		R8203	1-249-417-11	CARBON 1K 5%	1/4W
Q8602	8-729-281-52	TRANSISTOR 2SC1815-Y		R8204	1-247-895-00	CARBON 470K 5%	1/4W
				R8205	1-249-404-00	CARBON 82 5%	1/4W
Q8603	8-729-119-78	TRANSISTOR 2SC2785-HFE		R8206	1-249-417-11	CARBON 1K 5%	1/4W
Q8604	8-729-281-52	TRANSISTOR 2SC1815-Y		R8207	1-247-895-00	CARBON 470K 5%	1/4W
Q8605	8-729-119-78	TRANSISTOR 2SC2785-HFE					
Q8606	8-729-119-78	TRANSISTOR 2SC2785-HFE		R8208	1-249-417-11	CARBON 1K 5%	1/4W
Q8607	8-729-119-78	TRANSISTOR 2SC2785-HFE		R8209	1-247-895-00	CARBON 470K 5%	1/4W
				R8210	1-249-417-11	CARBON 1K 5%	1/4W
Q8608	8-729-119-76	TRANSISTOR 2SA1175-HFE		R8211	1-249-404-00	CARBON 82 5%	1/4W
Q8609	8-729-119-76	TRANSISTOR 2SA1175-HFE		R8212	1-249-417-11	CARBON 1K 5%	1/4W
Q8610	8-729-900-89	TRANSISTOR DTC144ES					
<RESISTOR>				R8213	1-247-895-00	CARBON 470K 5%	1/4W
R101	1-249-433-11	CARBON 22K 5%	1/4W	R8214	1-249-417-11	CARBON 1K 5%	1/4W
R102	1-249-433-11	CARBON 22K 5%	1/4W	R8215	1-247-895-00	CARBON 470K 5%	1/4W
R103	1-249-433-11	CARBON 22K 5%	1/4W	R8216	1-249-403-11	CARBON 68 5%	1/4W
R104	1-249-433-11	CARBON 22K 5%	1/4W	R8217	1-249-416-11	CARBON 820 5%	1/4W
R105	1-249-433-11	CARBON 22K 5%	1/4W				
				R8218	1-249-417-11	CARBON 1K 5%	1/4W
R106	1-249-433-11	CARBON 22K 5%	1/4W	R8219	1-249-437-11	CARBON 47K 5%	1/4W
R107	1-249-433-11	CARBON 22K 5%	1/4W	R8220	1-249-417-11	CARBON 1K 5%	1/4W
R108	1-249-433-11	CARBON 22K 5%	1/4W	R8221	1-249-437-11	CARBON 47K 5%	1/4W
R8001	1-249-405-11	CARBON 100 5%	1/4W	R8222	1-249-417-11	CARBON 1K 5%	1/4W
R8004	1-249-421-11	CARBON 2.2K 5%	1/4W				
				R8223	1-249-437-11	CARBON 47K 5%	1/4W
R8005	1-249-401-11	CARBON 47 5%	1/4W	R8224	1-249-417-11	CARBON 1K 5%	1/4W
R8006	1-247-696-11	CARBON 47 5%	1/4W	R8225	1-249-437-11	CARBON 47K 5%	1/4W
R8100	1-249-405-11	CARBON 100 5%	1/4W	R8328	1-249-420-11	CARBON 1.8K 5%	1/4W
R8101	1-249-429-11	CARBON 10K 5%	1/4W	R8329	1-249-420-11	CARBON 1.8K 5%	1/4W
R8102	1-249-437-11	CARBON 47K 5%	1/4W				
				R8400	1-249-421-11	CARBON 2.2K 5%	1/4W
R8103	1-249-429-11	CARBON 10K 5%	1/4W	R8401	1-249-413-11	CARBON 470 5%	1/4W
R8104	1-249-441-11	CARBON 100K 5%	1/4W	R8402	1-249-417-11	CARBON 1K 5%	1/4W
R8105	1-249-437-11	CARBON 47K 5%	1/4W	R8403	1-249-425-11	CARBON 4.7K 5%	1/4W
R8106	1-249-441-11	CARBON 100K 5%	1/4W	R8404	1-249-423-11	CARBON 3.3K 5%	1/4W
R8107	1-249-429-11	CARBON 10K 5%	1/4W				
				R8405	1-247-903-00	CARBON 1M 5%	1/4W
R8108	1-249-441-11	CARBON 100K 5%	1/4W	R8406	1-249-405-11	CARBON 100 5%	1/4W
R8109	1-249-441-11	CARBON 100K 5%	1/4W	R8407	1-249-421-11	CARBON 2.2K 5%	1/4W
R8110	1-249-423-11	CARBON 3.3K 5%	1/4W	R8408	1-249-432-11	CARBON 18K 5%	1/4W
R8111	1-249-419-11	CARBON 1.5K 5%	1/4W	R8409	1-249-429-11	CARBON 10K 5%	1/4W
R8112	1-215-406-00	METAL 240 1%	1/6W				
				R8410	1-249-429-11	CARBON 10K 5%	1/4W
R8113	1-215-397-00	METAL 100 1%	1/6W	R8411	1-249-441-11	CARBON 100K 5%	1/4W
R8114	1-215-415-00	METAL 560 1%	1/6W	R8412	1-249-401-11	CARBON 47 5%	1/4W
R8115	1-249-429-11	CARBON 10K 5%	1/4W	R8413	1-249-421-11	CARBON 2.2K 5%	1/4W
				R8500	1-249-417-11	CARBON 1K 5%	1/4W
				R8501	1-249-417-11	CARBON 1K 5%	1/4W

REF.NO.	PART NO.	DESCRIPTION	REMARK	REF.NO.	PART NO.	DESCRIPTION	REMARK
R8502	1-249-426-11	CARBON	5.6K 5% 1/4W	R8633	1-249-401-11	CARBON 47 5% 1/4W	
R8503	1-249-426-11	CARBON	5.6K 5% 1/4W	R8634	1-249-405-11	CARBON 100 5% 1/4W	
R8504	1-249-426-11	CARBON	5.6K 5% 1/4W	R8635	1-249-421-11	CARBON 2.2K 5% 1/4W	
R8505	1-249-426-11	CARBON	5.6K 5% 1/4W	R8636	1-249-405-11	CARBON 100 5% 1/4W	
R8506	1-249-417-11	CARBON	1K 5% 1/4W	R8637	1-249-421-11	CARBON 2.2K 5% 1/4W	
R8507	1-247-887-00	CARBON	220K 5% 1/4W	R8640	1-249-418-11	CARBON 1.2K 5% 1/4W	
R8508	1-249-422-11	CARBON	2.7K 5% 1/4W	R8641	1-249-418-11	CARBON 1.2K 5% 1/4W	
R8509	1-249-441-11	CARBON	100K 5% 1/4W	R8800A	1-249-415-91	CARBON 680 5% 1/4W	F
R8510	1-249-441-11	CARBON	100K 5% 1/4W				
R8511	1-249-430-11	CARBON	12K 5% 1/4W				
R8512	1-249-430-11	CARBON	12K 5% 1/4W				
R8513	1-249-438-11	CARBON	56K 5% 1/4W				
R8514	1-249-433-11	CARBON	22K 5% 1/4W				
R8515	1-249-425-11	CARBON	4.7K 5% 1/4W				
R8516	1-249-431-11	CARBON	15K 5% 1/4W				
R8517	1-249-431-11	CARBON	15K 5% 1/4W				
R8518	1-249-438-11	CARBON	56K 5% 1/4W				
R8519	1-249-433-11	CARBON	22K 5% 1/4W				
R8520	1-249-425-11	CARBON	4.7K 5% 1/4W				
R8521	1-249-431-11	CARBON	15K 5% 1/4W				
R8522	1-249-431-11	CARBON	15K 5% 1/4W				
R8523	1-249-431-11	CARBON	15K 5% 1/4W				
R8524	1-249-431-11	CARBON	15K 5% 1/4W				
R8525	1-249-425-11	CARBON	4.7K 5% 1/4W				
R8526	1-249-425-11	CARBON	4.7K 5% 1/4W				
R8527	1-249-433-11	CARBON	22K 5% 1/4W				
R8528	1-249-433-11	CARBON	22K 5% 1/4W				
R8529	1-249-431-11	CARBON	15K 5% 1/4W				
R8530	1-249-431-11	CARBON	15K 5% 1/4W				
R8531	1-249-405-11	CARBON	100 5% 1/4W				
R8532	1-249-421-11	CARBON	2.2K 5% 1/4W				
R8533	1-249-421-11	CARBON	2.2K 5% 1/4W				
R8600	1-249-413-11	CARBON	470 5% 1/4W				
R8601	1-249-404-00	CARBON	82 5% 1/4W				
R8602	1-249-422-11	CARBON	2.7K 5% 1/4W				
R8603	1-249-419-11	CARBON	1.5K 5% 1/4W				
R8604	1-249-418-11	CARBON	1.2K 5% 1/4W				
R8605	1-215-406-00	METAL	240 1% 1/6W				
R8606	1-215-399-00	METAL	120 1% 1/6W				
R8607	1-215-415-00	METAL	560 1% 1/6W				
R8608	1-249-429-11	CARBON	10K 5% 1/4W				
R8609	1-249-422-11	CARBON	2.7K 5% 1/4W				
R8610	1-249-404-00	CARBON	82 5% 1/4W				
R8611	1-249-422-11	CARBON	2.7K 5% 1/4W				
R8612	1-249-419-11	CARBON	1.5K 5% 1/4W				
R8613	1-249-418-11	CARBON	1.2K 5% 1/4W				
R8614	1-215-406-00	METAL	240 1% 1/6W				
R8615	1-215-399-00	METAL	120 1% 1/6W				
R8616	1-215-415-00	METAL	560 1% 1/6W				
R8617	1-249-429-11	CARBON	10K 5% 1/4W				
R8618	1-249-422-11	CARBON	2.7K 5% 1/4W				
R8619	1-249-441-11	CARBON	100K 5% 1/4W				
R8620	1-249-441-11	CARBON	100K 5% 1/4W				
R8621	1-249-437-11	CARBON	47K 5% 1/4W				
R8622	1-249-405-11	CARBON	100 5% 1/4W				
R8623	1-247-895-00	CARBON	470K 5% 1/4W				
R8624	1-249-441-11	CARBON	100K 5% 1/4W				
R8625	1-249-418-11	CARBON	1.2K 5% 1/4W				
R8626	1-249-421-11	CARBON	2.2K 5% 1/4W				
R8627	1-249-405-11	CARBON	100 5% 1/4W				
R8628	1-249-405-11	CARBON	100 5% 1/4W				
R8629	1-249-405-11	CARBON	100 5% 1/4W				
R8630	1-249-413-11	CARBON	470 5% 1/4W				
R8632	1-249-401-11	CARBON	47 5% 1/4W				

REF.NO.	PART NO.	DESCRIPTION	REMARK	REF.NO.	PART NO.	DESCRIPTION	REMARK
	*1-625-933-11	YG BOARD *****		C012	1-163-020-00	CERAMIC CHIP 0.0082MF	5% 50V
	*4-341-752-01	EYELET		C013	1-163-037-11	CERAMIC CHIP 0.022MF	10% 25V
		<CAPACITOR>		C014	1-163-017-00	CERAMIC CHIP 0.0047MF	10% 50V
C3	1-162-115-00	CERAMIC 330PF	10% 2KV	C015	1-163-133-00	CERAMIC CHIP 470PF	5% 50V
C4	1-162-115-00	CERAMIC 330PF	10% 2KV				
		<RESISTOR>		C017	1-164-004-11	CERAMIC CHIP 0.1MF	10% 25V
R5	1-202-822-00	SOLID 2.2K 10%	1/2W	C018	1-164-232-11	CERAMIC CHIP 0.01MF	10% 50V
R6	1-202-822-00	SOLID 2.2K 10%	1/2W	C019	1-164-161-11	CERAMIC CHIP 0.0022MF	10% 50V
R7	1-260-096-91	CARBON 560 5%	1/2W	C020	1-163-809-11	CERAMIC CHIP 0.047MF	5% 25V
R8	1-260-096-91	CARBON 560 5%	1/2W	C021	1-164-161-11	CERAMIC CHIP 0.0022MF	5% 50V
		<CONNECTOR>		C022	1-124-257-00	ELECT 2.2MF	20% 50V
YG1	*1-565-426-11	PLUG, MINIATURE (L TYPE) 4P		C023	1-163-121-00	CERAMIC CHIP 150PF	5% 50V
YG2	*1-564-518-11	PLUG, CONNECTOR 3P		C024	1-130-491-00	MYLAR 0.047MF	5% 50V
*****				C025	1-163-121-00	CERAMIC CHIP 150PF	5% 50V
	*1-625-934-11	YB BOARD *****		C026	1-130-491-00	MYLAR 0.047MF	5% 50V
	*4-341-752-01	EYELET		C027	1-136-177-00	FILM 1MF	5% 50V
		<CAPACITOR>		C028	1-163-809-11	CERAMIC CHIP 0.047MF	5% 25V
C5	1-162-115-00	CERAMIC 330PF	10% 2KV	C029	1-126-163-11	ELECT 4.7MF	20% 25V
C6	1-162-115-00	CERAMIC 330PF	10% 2KV	C032	1-136-177-00	FILM 1MF	5% 50V
		<RESISTOR>		C033	1-164-161-11	CERAMIC CHIP 0.0022MF	5% 50V
R9	1-202-822-00	SOLID 2.2K 10%	1/2W	C034	1-126-163-11	ELECT 4.7MF	20% 25V
R10	1-202-822-00	SOLID 2.2K 10%	1/2W	C035	1-136-177-00	FILM 1MF	5% 50V
R11	1-260-096-91	CARBON 560 5%	1/2W	C036	1-126-301-11	ELECT 1MF	20% 50V
R12	1-260-096-91	CARBON 560 5%	1/2W	C037	1-163-109-00	CERAMIC CHIP 47PF	5% 50V
		<CONNECTOR>		C038	1-163-133-00	CERAMIC CHIP 470PF	5% 50V
YB1	*1-565-426-11	PLUG, MINIATURE (L TYPE) 4P		C039	1-126-301-11	ELECT 1MF	20% 50V
YB2	*1-564-518-11	PLUG, CONNECTOR 3P		C040	1-164-004-11	CERAMIC CHIP 0.1MF	10% 25V
*****				C041	1-136-171-00	FILM 0.33MF	5% 50V
	*A-1394-227-A	SX BOARD, COMPLETE *****		C042	1-164-004-11	CERAMIC CHIP 0.1MF	10% 25V
	*1-568-710-11	POST, BASE 24P		C043	1-136-177-00	FILM 1MF	5% 50V
		<CAPACITOR>		C044	1-126-163-11	ELECT 4.7MF	20% 25V
C001	1-124-257-00	ELECT 2.2MF	20% 50V	C045	1-126-301-11	ELECT 1MF	20% 50V
C002	1-124-257-00	ELECT 2.2MF	20% 50V	C046	1-163-133-00	CERAMIC CHIP 470PF	5% 50V
C003	1-163-145-00	CERAMIC CHIP 0.0015MF	5% 50V	C047	1-163-109-00	CERAMIC CHIP 47PF	5% 50V
C004	1-163-138-00	CERAMIC CHIP 750PF	5% 50V	C048	1-126-301-11	ELECT 1MF	20% 50V
C005	1-164-161-11	CERAMIC CHIP 0.0022MF	5% 50V	C049	1-136-177-00	FILM 1MF	5% 50V
C006	1-163-020-00	CERAMIC CHIP 0.0082MF	5% 50V	C050	1-126-163-11	ELECT 4.7MF	20% 25V
C007	1-163-020-00	CERAMIC CHIP 0.0082MF	5% 50V	C051	1-163-809-11	CERAMIC CHIP 0.047MF	5% 25V
C008	1-163-020-00	CERAMIC CHIP 0.0082MF	5% 50V	C052	1-124-477-11	ELECT 47MF	20% 25V
C009	1-126-301-11	ELECT 1MF	20% 50V	C053	1-136-177-00	FILM 1MF	5% 50V
C010	1-163-020-00	CERAMIC CHIP 0.0082MF	5% 50V	C054	1-126-163-11	ELECT 4.7MF	20% 25V
C011	1-163-020-00	CERAMIC CHIP 0.0082MF	5% 50V	C055	1-136-177-00	FILM 1MF	5% 50V
				C056	1-124-261-00	ELECT 10MF	20% 50V
				C057	1-136-177-00	FILM 1MF	5% 50V
				C058	1-126-163-11	ELECT 4.7MF	20% 25V
				C059	1-163-111-00	CERAMIC CHIP 56PF	5% 50V
				C060	1-163-125-00	CERAMIC CHIP 220PF	5% 50V
				C061	1-124-257-00	ELECT 2.2MF	20% 50V
				C062	1-126-301-11	ELECT 1MF	20% 50V
				C063	1-163-111-00	CERAMIC CHIP 56PF	5% 50V
				C064	1-126-163-11	ELECT 4.7MF	20% 25V
				C065	1-136-177-00	FILM 1MF	5% 50V
				C066	1-124-261-00	ELECT 10MF	20% 50V
				C072	1-163-141-00	CERAMIC CHIP 0.001MF	5% 50V
				C073	1-163-141-00	CERAMIC CHIP 0.001MF	5% 50V
				C074	1-126-163-11	ELECT 4.7MF	20% 25V
				C075	1-126-163-11	ELECT 4.7MF	20% 25V
				C080	1-126-301-11	ELECT 1MF	20% 50V
				C081	1-126-163-11	ELECT 4.7MF	20% 25V
				C082	1-126-163-11	ELECT 4.7MF	20% 25V
				C083	1-126-163-11	ELECT 4.7MF	20% 25V
				C084	1-126-163-11	ELECT 4.7MF	20% 25V
				C085	1-126-163-11	ELECT 4.7MF	20% 25V
				C086	1-126-163-11	ELECT 4.7MF	20% 25V
				C087	1-126-157-11	ELECT 10MF	20% 16V

REF.NO.	PART NO.	DESCRIPTION	REMARK	REF.NO.	PART NO.	DESCRIPTION	REMARK		
C088	1-124-239-00	ELECT	6.8MF	20%	25V				
C089	1-126-163-11	ELECT	4.7MF	20%	25V				
<IC>									
IC001	8-759-031-31	IC MC33174M		R038	1-216-073-00	METAL GLAZE	10K 5% 1/10W		
IC002	8-759-035-30	IC MC4741CM		R039	1-216-073-00	METAL GLAZE	10K 5% 1/10W		
IC003	8-759-035-30	IC MC4741CM		R041	1-216-081-00	METAL GLAZE	22K 5% 1/10W		
IC004	8-759-031-31	IC MC33174M		R042	1-216-085-00	METAL GLAZE	33K 5% 1/10W		
IC005	8-759-031-31	IC MC33174M		R043	1-216-081-00	METAL GLAZE	22K 5% 1/10W		
IC006	8-759-035-30	IC MC4741CM		R044	1-216-073-00	METAL GLAZE	10K 5% 1/10W		
IC007	8-759-035-30	IC MC4741CM		R045	1-216-083-00	METAL GLAZE	27K 5% 1/10W		
IC010	8-759-009-06	IC MC14052BF		R046	1-216-073-00	METAL GLAZE	10K 5% 1/10W		
IC011	8-759-008-67	IC MC14066BF		R047	1-216-073-00	METAL GLAZE	10K 5% 1/10W		
IC021	8-752-038-21	IC CXA1411Q		R048	1-216-073-00	METAL GLAZE	10K 5% 1/10W		
IC022	8-752-038-22	IC CXA1412Q		R049	1-216-073-00	METAL GLAZE	10K 5% 1/10W		
<TRANSISTOR>									
Q002-A 8-729-120-28 TRANSISTOR 25K1623-1514									
<RESISTOR>									
Q003	1-216-295-00	METAL GLAZE	0	5%	1/10W	R056	1-216-081-00	METAL GLAZE	22K 5% 1/10W
Q004	1-216-295-00	METAL GLAZE	0	5%	1/10W	R057	1-216-085-00	METAL GLAZE	33K 5% 1/10W
Q050	1-216-295-00	METAL GLAZE	0	5%	1/10W	R058	1-216-073-00	METAL GLAZE	10K 5% 1/10W
R001	1-216-086-00	METAL GLAZE	36K	5%	1/10W	R059	1-216-073-00	METAL GLAZE	10K 5% 1/10W
R002	1-216-075-00	METAL GLAZE	12K	5%	1/10W	R060	1-216-065-00	METAL GLAZE	4.7K 5% 1/10W
R003	1-216-086-00	METAL GLAZE	36K	5%	1/10W	R062	1-216-065-00	METAL GLAZE	4.7K 5% 1/10W
R004	1-216-075-00	METAL GLAZE	12K	5%	1/10W	R064	1-216-065-00	METAL GLAZE	4.7K 5% 1/10W
R005	1-216-073-00	METAL GLAZE	10K	5%	1/10W	R066	1-216-069-00	METAL GLAZE	6.8K 5% 1/10W
R006	1-216-089-00	METAL GLAZE	47K	5%	1/10W	R067	1-216-065-00	METAL GLAZE	4.7K 5% 1/10W
R007	1-216-073-00	METAL GLAZE	10K	5%	1/10W	R068	1-218-148-11	METAL GLAZE	910 1% 1/10W
R008	1-216-073-00	METAL GLAZE	10K	5%	1/10W	R069	1-216-065-00	METAL GLAZE	4.7K 5% 1/10W
R009	1-216-073-00	METAL GLAZE	10K	5%	1/10W	R070	1-216-196-00	METAL GLAZE	820 5% 1/8W
R010	1-216-089-00	METAL GLAZE	47K	5%	1/10W	R071	1-216-069-00	METAL GLAZE	6.8K 5% 1/10W
R011	1-216-073-00	METAL GLAZE	10K	5%	1/10W	R072	1-216-041-00	METAL GLAZE	470 5% 1/10W
R012	1-216-081-00	METAL GLAZE	22K	5%	1/10W	R073	1-218-132-11	METAL GLAZE	4.7K 1% 1/10W
R013	1-216-081-00	METAL GLAZE	22K	5%	1/10W	R074	1-216-602-11	METAL GLAZE	6.8K 1% 1/10W
R014	1-216-073-00	METAL GLAZE	10K	5%	1/10W	R075	1-216-042-00	METAL GLAZE	510 5% 1/10W
R015	1-216-073-00	METAL GLAZE	10K	5%	1/10W	R076	1-216-061-00	METAL GLAZE	3.3K 5% 1/10W
R016	1-216-049-00	METAL GLAZE	1K	5%	1/10W	R078	1-216-596-11	METAL GLAZE	2.7K 1% 1/10W
R017	1-216-077-00	METAL GLAZE	15K	5%	1/10W	R080	1-216-542-11	METAL GLAZE	12K 1% 1/10W
R018	1-216-073-00	METAL GLAZE	10K	5%	1/10W	R083	1-216-226-00	METAL GLAZE	15K 5% 1/8W
R019	1-216-073-00	METAL GLAZE	10K	5%	1/10W	R084	1-216-773-11	METAL GLAZE	68K 1% 1/10W
R020	1-216-748-11	METAL GLAZE	39K	1%	1/10W	R085	1-216-033-00	METAL GLAZE	220 5% 1/10W
R021	1-216-091-00	METAL GLAZE	56K	1%	1/10W	R087	1-216-097-00	METAL GLAZE	100K 5% 1/10W
R022	1-218-167-11	METAL GLAZE	330K	1%	1/10W	R088	1-218-132-11	METAL GLAZE	4.7K 1% 1/10W
R023	1-216-339-11	METAL GLAZE	18K	1%	1/10W	R089	1-216-041-00	METAL GLAZE	470 5% 1/10W
R024	1-216-324-11	METAL GLAZE	10K	1%	1/10W	R090	1-216-042-00	METAL GLAZE	510 5% 1/10W
R025	1-216-868-11	METAL GLAZE	13K	1%	1/10W	R091	1-216-602-11	METAL GLAZE	6.8K 1% 1/10W
R026	1-216-091-00	METAL GLAZE	56K	1%	1/10W	R092	1-216-061-00	METAL GLAZE	3.3K 5% 1/10W
R027	1-216-339-11	METAL GLAZE	18K	1%	1/10W	R093	1-216-596-11	METAL GLAZE	2.7K 1% 1/10W
R028	1-218-167-11	METAL GLAZE	330K	1%	1/10W	R096	1-216-542-11	METAL GLAZE	12K 1% 1/10W
R029	1-216-324-11	METAL GLAZE	10K	1%	1/10W	R099	1-216-226-00	METAL GLAZE	15K 5% 1/8W
R030	1-216-868-11	METAL GLAZE	13K	1%	1/10W	R0100	1-216-773-11	METAL GLAZE	68K 1% 1/10W
R031	1-216-081-00	METAL GLAZE	22K	5%	1/10W	R0101	1-216-033-00	METAL GLAZE	220 5% 1/10W
R032	1-216-748-11	METAL GLAZE	39K	5%	1/10W	R0103	1-216-097-00	METAL GLAZE	100K 5% 1/10W
R033	1-216-081-00	METAL GLAZE	22K	5%	1/10W	R0104	1-216-324-11	METAL GLAZE	10K 1% 1/10W
R034	1-216-073-00	METAL GLAZE	10K	5%	1/10W	R0105	1-218-167-11	METAL GLAZE	330K 1% 1/10W
R035	1-216-079-00	METAL GLAZE	18K	5%	1/10W	R0106	1-218-158-11	METAL GLAZE	27K 1% 1/10W
R036	1-216-073-00	METAL GLAZE	10K	5%	1/10W	R0107	1-216-025-00	METAL GLAZE	100 5% 1/10W
R037	1-216-073-00	METAL GLAZE	10K	5%	1/10W	R0108	1-216-334-11	METAL GLAZE	22K 1% 1/10W
						R0109	1-218-160-11	METAL GLAZE	43K 1% 1/10W
						R0110	1-216-088-00	METAL GLAZE	43K 5% 1/10W
						R0113	1-216-113-00	METAL GLAZE	470K 5% 1/10W
						R0114	1-216-097-00	METAL GLAZE	100K 5% 1/10W
						R0115	1-216-089-00	METAL GLAZE	47K 5% 1/10W
						R0116	1-216-089-00	METAL GLAZE	47K 5% 1/10W
						R0117	1-218-158-11	METAL GLAZE	27K 1% 1/10W
						R0118	1-216-331-11	METAL GLAZE	9.1K 1% 1/10W

REF.NO.	PART NO.	DESCRIPTION	REMARK
RO119	1-216-113-00	METAL GLAZE 470K 5%	1/10W
RO120	1-216-097-00	METAL GLAZE 100K 1%	1/10W
RO121	1-216-113-00	METAL GLAZE 470K 5%	1/10W
RO122	1-216-113-00	METAL GLAZE 470K 5%	1/10W
RO123	1-216-077-00	METAL GLAZE 15K 5%	1/10W
RO124	1-216-748-11	METAL GLAZE 39K 1%	1/10W
RO125	1-216-097-00	METAL GLAZE 100K 1%	1/10W
RO126	1-216-113-00	METAL GLAZE 470K 5%	1/10W
RO127	1-216-331-11	METAL GLAZE 9.1K 1%	1/10W
RO128	1-216-688-11	METAL GLAZE 36K 1%	1/10W
RO129	1-216-089-00	METAL GLAZE 47K 5%	1/10W
RO130	1-216-089-00	METAL GLAZE 47K 5%	1/10W
RO131	1-216-097-00	METAL GLAZE 100K 5%	1/10W
RO132	1-216-113-00	METAL GLAZE 470K 5%	1/10W
RO133	1-216-113-00	METAL GLAZE 470K 5%	1/10W
RO134	1-216-113-00	METAL GLAZE 470K 5%	1/10W
RO135	1-216-097-00	METAL GLAZE 100K 5%	1/10W
RO136	1-216-089-00	METAL GLAZE 47K 5%	1/10W
RO137	1-216-089-00	METAL GLAZE 47K 5%	1/10W
RO138	1-216-094-00	METAL GLAZE 75K 1%	1/10W
RO139	1-216-294-00	METAL GLAZE 10M 5%	1/8W
RO140	1-216-335-11	METAL GLAZE 24K 1%	1/10W
RO141	1-216-113-00	METAL GLAZE 470K 5%	1/10W
RO142	1-216-101-00	METAL GLAZE 150K 1%	1/10W
RO143	1-216-338-11	METAL GLAZE 30K 1%	1/10W
RO144	1-216-073-00	METAL GLAZE 10K 5%	1/10W
RO145	1-216-073-00	METAL GLAZE 10K 5%	1/10W
RO146	1-216-073-00	METAL GLAZE 10K 5%	1/10W
RO147	1-216-075-00	METAL GLAZE 12K 5%	1/10W
RO148	1-216-748-11	METAL GLAZE 39K 1%	1/10W
RO149	1-216-748-11	METAL GLAZE 39K 1%	1/10W
RO150	1-216-338-11	METAL GLAZE 30K 1%	1/10W
RO151	1-216-101-00	METAL GLAZE 150K 1%	1/10W
RO152	1-216-113-00	METAL GLAZE 470K 5%	1/10W
RO153	1-216-335-11	METAL GLAZE 24K 1%	1/10W
RO154	1-216-294-00	METAL GLAZE 10M 5%	1/8W
RO155	1-216-094-00	METAL GLAZE 75K 1%	1/10W
RO156	1-216-089-00	METAL GLAZE 47K 5%	1/10W
RO157	1-216-089-00	METAL GLAZE 47K 5%	1/10W
RO158	1-216-097-00	METAL GLAZE 100K 5%	1/10W
RO159	1-216-089-00	METAL GLAZE 47K 5%	1/10W
RO160	1-216-049-00	METAL GLAZE 1K 5%	1/10W
RO161	1-216-049-00	METAL GLAZE 1K 5%	1/10W
RO162	1-216-073-00	METAL GLAZE 10K 5%	1/10W
RO163	1-216-073-00	METAL GLAZE 10K 5%	1/10W
RO180	1-216-097-00	METAL GLAZE 100K 5%	1/10W
RO181	1-216-089-00	METAL GLAZE 47K 5%	1/10W
RO182	1-216-091-00	METAL GLAZE 56K 5%	1/10W
RO183	1-216-073-00	METAL GLAZE 10K 5%	1/10W
RO199	1-215-420-00	METAL 910 1%	1/6W

<VARIABLE RESISTOR>

RV001	1-238-015-11	RES. ADJ. CARBON 4.7K
RV002	1-238-015-11	RES. ADJ. CARBON 4.7K
RV003	1-238-015-11	RES. ADJ. CARBON 4.7K
RV004	1-238-015-11	RES. ADJ. CARBON 4.7K

*4-341-751-01 EYELET (EY601,EY602,EY603,EY612,EY613,EY614,EY615,EY616,EY617,EY618,EY619,EY620,EY621,EY622,EY623,EY624,EY625,EY626,EY627,EY633,EY634,EY635,EY636)

REF.NO.	PART NO.	DESCRIPTION	REMARK
	*4-341-752-01	EYELET (EY631,EY632)	
	9-832-321-21	WIRE KIT (2D-106A)	

<CAPACITOR>

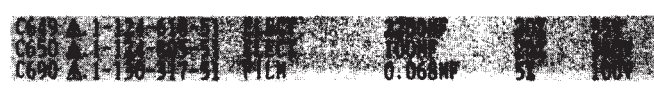
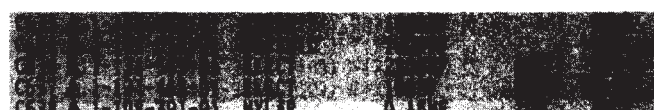
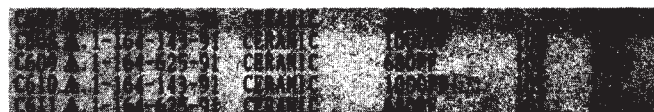
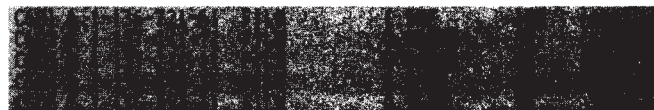

<DIODE>

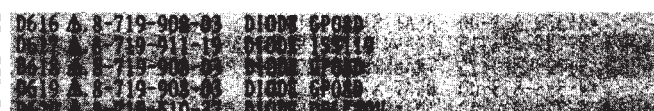
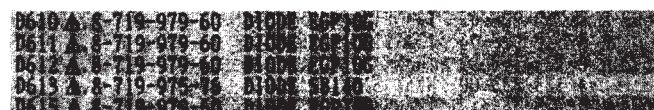
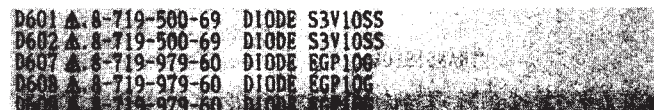

REF.NO.	PART NO.	DESCRIPTION	REMARK
---------	----------	-------------	--------

R645	Δ.1-247-873-81	CARBON 56K 5% 1/4W	
R646	Δ.1-247-879-81	CARBON 100K 5% 1/4W	
R647	Δ.1-247-833-81	CARBON 1.2K 5% 1/4W	
R648	Δ.1-247-833-81	CARBON 1.2K 5% 1/4W	
R649	Δ.1-247-855-81	CARBON 10K 5% 1/4W	

☒ R690	Δ.	METAL	1/6W
☒ R691	Δ.	METAL	1/6W
R692	Δ.1-247-849-81	CARBON 5.6K 5% 1/4W	
R693	Δ.1-247-831-81	CARBON 1K 5% 1/4W	
R694	Δ.1-247-845-81	CARBON 3.9K 5% 1/4W	

R695	Δ.1-247-691-51	CARBON 18 5% 1/4W P	
R696	Δ.1-247-855-81	CARBON 10K 5% 1/4W	
R697	Δ.1-249-382-91	CARBON 1.2 5% 1/4W P	

<VARIABLE RESISTOR>

RV601A	Δ.1-238-012-41	RES. ADJ. CARBON 1K	
RV602A	Δ.1-238-012-41	RES. ADJ. CARBON 1K	
RV603A	Δ.1-238-012-41	RES. ADJ. CARBON 1K	

<TRANSFORMER>

T601	Δ.1-424-023-12	TRANSFORMER, LINE FILTER	
T602	Δ.1-424-020-11	PRT	
T605	Δ.1-424-390-22	TRANSFORMER, FERRITE POWER	
T606	Δ.1-424-023-12	TRANSFORMER, LINE FILTER	
T607	Δ.1-450-149-11	TRANSFORMER, HEATER	

MISCELLANEOUS

Δ.1-237-582-21	RESISTOR ASSY, HIGH-VOLTAGE
Δ.1-417-177-11	SELECTOR, ANTENNA (AS-1)
Δ.1-451-322-11	DEFLECTION YOKE (Y636PA4)
Δ.1-452-443-13	NECK ASSY, PICTURE TUBE (NA367)
1-544-014-11	SPEAKER

*1-555-400-00	CABLE, PIN
Δ.1-559-396-12	CORD, POWER
Δ.8-734-021-05	PICTURE TUBE (SD-208(G))
Δ.8-734-022-05	PICTURE TUBE (SD-208(B))
Δ.8-734-023-05	PICTURE TUBE (SD-208(R))

ACCESSORIES AND PACKING MATERIALS

PART NO.	DESCRIPTION	REMARK
1-513-379-00	CONVERTER (EAC-25)	
3-752-931-21	MANUAL, INSTRUCTION (ENGLISH)	
*4-030-895-01	JOINT	
*4-031-107-01	TRAY	
*4-031-108-01	INDIVIDUAL CARTON	
*4-390-676-01	BAG, POLYETHYLENE	
*4-397-077-01	PLATE, TOP	
*4-397-078-01	PLATE	
*4-397-081-01	CUSHION (UPPER) (ASSY)	
*4-397-082-01	CUSHION (LOWER) (ASSY)	

REMOTE COMMANDER

1-465-780-11	REMOTE COMMANDER (RM-Y109)
3-707-584-01	COVER, BATTERY (FOR RM-Y109)

REF. NO. PART NO.

DESCRIPTION

REMARK

D623 A.8-719-500-67 DIODE D5KC40H
 D624 A.8-719-110-02 DIODE RD7.1ES-B1
 D626 A.8-719-109-85 DIODE RD5.1ES-B2
 D627 A.8-719-109-85 DIODE RD5.1ES-B2
 D628 A.8-719-109-85 DIODE RD5.1ES-B2

D629 A.8-719-110-50 DIODE RD18ES-B3
 D630 A.8-719-109-85 DIODE RD5.1ES-B2
 D631 A.8-719-911-19 DIODE ISS119
 D632 A.8-719-911-19 DIODE ISS119
 D633 A.8-719-110-50 DIODE RD18ES-B3

D634 A.8-719-911-19 DIODE ISS119
 D635 A.8-719-975-76 DIODE S8140

<COIL>

FB601A 1-410-396-51 FERRITE BEAD INDUCTOR 0.45UH
 FB602A 1-410-396-51 FERRITE BEAD INDUCTOR 0.45UH
 FB603A 1-410-396-51 FERRITE BEAD INDUCTOR 0.45UH
 FB604A 1-410-397-31 FERRITE BEAD INDUCTOR 1.10UH
 FB605A 1-410-396-51 FERRITE BEAD INDUCTOR 0.45UH

FB606A 1-410-397-31 FERRITE BEAD INDUCTOR 1.10UH
 FB607A 1-410-397-31 FERRITE BEAD INDUCTOR 1.10UH
 FB608A 1-410-396-51 FERRITE BEAD INDUCTOR 0.45UH
 FB610A 1-410-397-31 FERRITE BEAD INDUCTOR 1.10UH
 FB611A 1-410-396-51 FERRITE BEAD INDUCTOR 0.45UH

L601 A.1-408-598-41 INDUCTOR (EL TYPE) 3.90UH
 L602 A.1-408-598-41 INDUCTOR (EL TYPE) 3.90UH
 L603 A.9-832-965-11 WIRE KIT (COIL, ARE-CORE)
 L604 A.9-832-913-21 WIRE KIT (COIL, ARE-CORE)
 L605 A.9-832-965-11 WIRE KIT (COIL, ARE-CORE)

L606 A.9-832-313-21 WIRE KIT (COIL, ARE-CORE)
 L619 A.1-459-484-11 COIL (WITH CORE)
 L620 A.1-412-415-22 INDUCTOR 47UH
 L621 A.1-410-668-41 INDUCTOR 27UH

<CONNECTOR>

G1 A.*1-508-765-11 PIN, CONNECTOR (5MM PITCH) 3P
 G2 A.*1-564-512-31 PLUG, CONNECTOR 9P
 G3 A.*1-564-506-51 PLUG, CONNECTOR 3P
 G4 A.*1-564-509-11 PLUG, CONNECTOR 6P
 G5 A.*1-564-507-51 PLUG, CONNECTOR 4P
 G6 A.*1-564-506-81 PLUG, CONNECTOR 3P
 G7 A.*1-508-786-11 PIN, CONNECTOR (5MM PITCH) 2P

<IC>

IC601A.8-749-921-89 IC SE115N

<TRANSISTOR>

Q601 A.8-729-926-03 TRANSISTOR 2SC4581N
 A.8-729-926-04 TRANSISTOR 2SC4581P
 Q602 A.8-729-926-03 TRANSISTOR 2SC4581N
 A.8-729-926-04 TRANSISTOR 2SC4581P
 Q603 A.8-729-313-82 TRANSISTOR 2SD1138-C
 *4-323-833-00 HEAT SINK, PIN OUT: Q603
 Q604 A.8-729-386-12 TRANSISTOR 2SB861-C

*4-323-833-00 HEAT SINK, PIN OUT: Q604
 Q605 A.8-729-423-35 TRANSISTOR 2SC3311A-R
 Q606 A.8-729-209-15 TRANSISTOR 2SD2012
 *4-323-833-00 HEAT SINK, PIN OUT: Q606
 Q607 A.8-729-820-83 TRANSISTOR 2SA1208-T

Q608 A.8-729-423-42 TRANSISTOR 2SA1309A-R
 A.8-729-255-12 TRANSISTOR 2SC2551-0

DESCRIPTION

REMARK

Q610 A.8-729-423-35 TRANSISTOR 2SC3311A-R
 Q611 A.8-729-255-12 TRANSISTOR 2SC2551-0
 Q612 A.8-729-423-35 TRANSISTOR 2SC3311A-R

Q613 A.8-729-255-12 TRANSISTOR 2SC2551-0
 Q614 A.8-729-168-83 TRANSISTOR 2SC2688-K
 Q615 A.8-729-255-12 TRANSISTOR 2SC2551-0
 Q616 A.8-729-820-83 TRANSISTOR 2SA1208-T
 Q617 A.8-729-820-83 TRANSISTOR 2SA1208-T

Q618 A.8-729-423-42 TRANSISTOR 2SA1309A-R
 Q619 A.8-729-201-53 TRANSISTOR 2SA1015-GR
 Q620 A.8-729-423-35 TRANSISTOR 2SC3311A-R
 Q621 A.8-729-423-42 TRANSISTOR 2SA1309A-R
 Q622 A.8-729-423-35 TRANSISTOR 2SC3311A-R

Q623 A.8-729-423-42 TRANSISTOR 2SA1309A-R

<RESISTOR>

R601 A.1-202-846-91 SOLID 470K 10% 1/2W
 R602 A.1-202-846-91 SOLID 470K 10% 1/2W
 R603 A.1-247-827-81 CARBON 680 5% 1/4W
 R604 A.1-247-831-81 CARBON 1K 5% 1/4W
 R605 A.1-247-855-81 CARBON 10K 5% 1/4W

R606 A.1-247-831-81 CARBON 1K 5% 1/4W
 R607 A.1-216-388-51 METAL OXIDE 0.82 5% 3W
 R608 A.1-216-389-51 METAL OXIDE 1.0 5% 3W
 R609 A.1-216-356-51 METAL OXIDE 3.9 5% 1W
 A.1-216-358-51 METAL OXIDE 5.6 5% 1W

R610 A.1-216-356-51 METAL OXIDE 3.9 5% 1W
 A.1-216-358-51 METAL OXIDE 5.6 5% 1W
 R611 A.1-215-897-51 METAL OXIDE 6.8K 5% 2W
 R612 A.1-244-803-91 CARBON 1.2 5% 1/2W
 R613 A.1-216-341-51 METAL OXIDE 0.22 5% 1W

R614 A.1-216-444-51 METAL OXIDE 82K 5% 1W
 R615 A.1-247-855-81 CARBON 10K 5% 1/4W
 R616 A.1-247-855-81 CARBON 10K 5% 1/4W
 R617 A.1-215-737-81 METAL 910 5% 1/4W
 R618 A.1-214-913-81 METAL 100K 1% 1/2W

R619 A.1-217-248-11 WIREWOUND 0.82 10% 3W
 R620 A.1-249-405-91 CARBON 100 5% 1/4W
 R621 A.1-249-405-91 CARBON 100 5% 1/4W
 R622 A.1-246-521-85 CARBON 100K 5% 1/4W
 R623 A.1-247-855-81 CARBON 10K 5% 1/4W

R624 A.1-249-382-91 CARBON 1.2 5% 1/4W
 R625 A.1-247-873-81 CARBON 56K 5% 1/4W
 R626 A.1-247-839-81 CARBON 2.2K 5% 1/4W
 R627 A.1-247-831-81 CARBON 1K 5% 1/4W
 R628 A.1-247-804-81 CARBON 75 5% 1/4W

R629 A.1-246-521-85 CARBON 100K 5% 1/4W
 R630 A.1-247-855-81 CARBON 10K 5% 1/4W
 R631 A.1-247-845-81 CARBON 3.9K 5% 1/4W
 R632 A.1-207-455-11 WIREWOUND 0.22 10% 1/2W
 R633 A.1-247-811-81 CARBON 150 5% 1/4W

R634 A.1-247-833-81 CARBON 1.2K 5% 1/4W
 R635 A.1-247-833-81 CARBON 1.2K 5% 1/4W
 R636 A.1-215-436-81 METAL 4.3K 1% 1/6W
 R637 A.1-215-436-81 METAL 4.3K 1% 1/6W
 R638 A.1-214-779-81 METAL 120K 1% 1/4W

R639 A.1-247-833-81 CARBON 1.2K 5% 1/4W
 R640 A.1-247-845-81 CARBON 3.9K 5% 1/4W
 R641 A.1-247-833-81 CARBON 1.2K 5% 1/4W
 R642 A.1-214-779-81 METAL 120K 1% 1/4W
 R643 A.1-215-429-81 METAL 2.2K 1% 1/6W

R644 A.1-214-915-81 METAL 120K 1% 1/2W