

标记	日期	姓名	变更内容
----	----	----	------

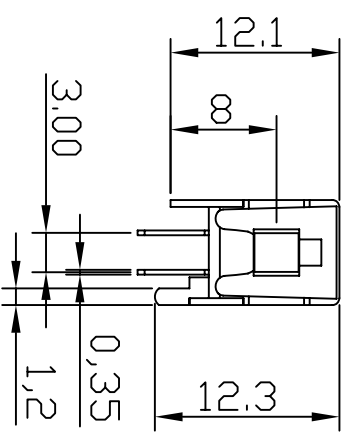
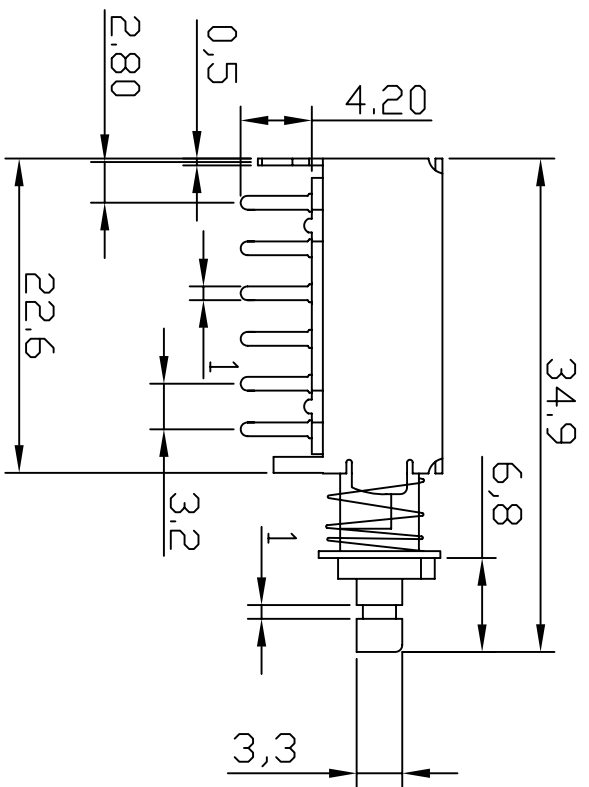
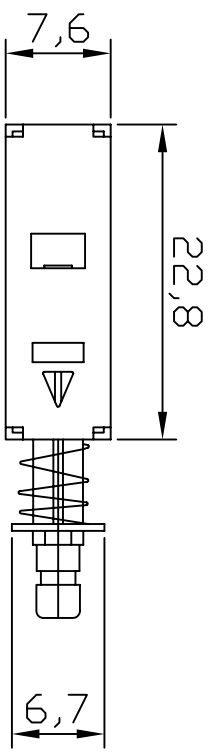

Function:	4P2T
Travel:	F: 3.0mm
Rating:	0.3A DC30V
Timing (Optional):	<input checked="" type="checkbox"/> S (Shorting) <input checked="" type="checkbox"/> NS (Non-shorting)
Contact resistance:	50mΩ max.
Insulation Resistance:	100MΩ at 500V DC
Withstand voltage:	AC 500V for 1minute
Operating force:	As Per Individual Specification
Switching life:	10,000 cycles min. Unloading 15-18 cycles per min.

设计 审核 批准 生效时间	未注公差尺寸	线性尺寸 ≤6~20 ±0.1 20~50 ±0.2 50~100 ±0.4 100 ±0.8	角度尺寸 ±2°	名称 型号: PS-42F09 料号:
	设计 审核 批准 生效时间	线性尺寸 ≤6~20 ±0.1 20~50 ±0.2 50~100 ±0.4 100 ±0.8	角度尺寸 ±2°	
名称 按键开关				单位: MM 版本: A1 第 1 页 共 1 页
YUEQING DAIER ELECTRON CO., LTD				比例: 1: 1